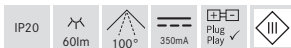
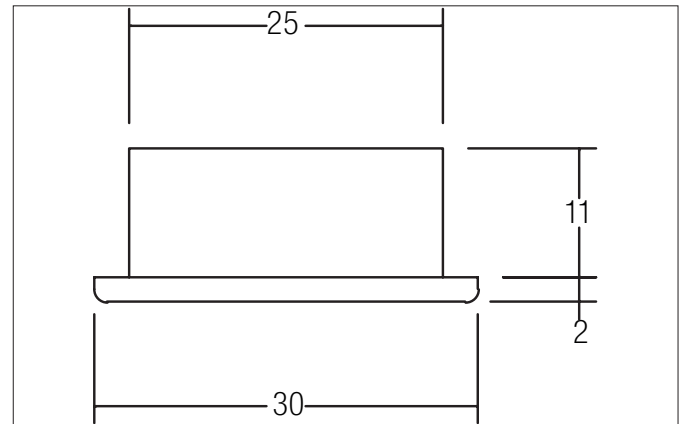

**RELATO LED light point**

Article no. P3605W

Light.  
For Generations.**Tender**

LED light point, Round. Ceiling cut-out Ø 25 mm, Installation depth 11 mm, Outer diameter 30 mm, Weight 0,011 kg, with rotationssymmetrical, deep, wide distributed light intensity. optimal light distribution due to a Without cover cover. Luminous flux 60 lm, Power 1 x 1 W, System Efficiency 60 lm/W, Light colour , Correlated color temprature (CCT) 6.500 K, Colour rendering index CRI > 80, Housing material: Plastic / Acrylic, Colour: Chrome, Permissible ambient temperature (ta): -20 °C - +25 °C, Protection class (EN 61140): III, Degree of protection (DIN EN 60529): IP20, .For connection to an external driver, which is not included in the scope of delivery of the luminaire. Depending on driver dimmable.

Article data	
Article no.	P3605W
GTIN	4250047704294
Series name	RELATO
Short description	LED light point
Material	Plastic / Acrylic
Colour	Chrome
Shape	Round
Outer diameter	30 mm
Built-in diameter	25 mm
Installation depth	11 mm
Hight	2 mm
Weight	0.011 kg

**RELATO LED light point**

Article no. P3605W

Light.  
For Generations.

Lighting technology	
Colour temperature	6.500 K
Light colour	White
Light output	Direct
Luminous flux	60 lm
System efficiency	60 lm/W
Colour rendering	CRI > 80
Reflector	Without
Beam angle	100°
Light sharing	Symmetric

Operating technology of the luminaire	
Voltage type	DC
Current	350 mA
Lamp	LED
Lamp holder	Plug&Play
Protection class	III
Degree of protection	IP20
Dimmable	Depending on type of control gear
Control	Depending on driver
Bulb change possible	The light source of this luminaire may only be replaced by the manufacturer or a service technician commissioned by him or a similarly qualified person.

Mounting technology	
Mounting method	Recessed mounting
Place of installation	Ceiling-mounted
Adjustability	Not adjustable
Further references	No cover with thermal insulation material
Material cover	Without cover

Packing data	
Gross weight	0.027 kg
Length of packaging	70 mm
Packaging width	47 mm
Packaging height	81 mm
Disposal at end of life	This product must not be disposed of with household waste. You are obliged, to dispose of such electrical waste separately. By disposing of electrical waste and other old or defective electronics separately, you support recycling or other forms of re-use. In that way you help to take care and to avoid that harmful substances get into the environment.

**RELATO LED light point**

Article no. P3605W



Light.  
For Generations.

Accessories	
	Article no.: 17666000 LED converter 350 mA, on/off switchable Power: 1 - 5 W Dimensions: 52 mm x 30 mm x 23 mm
	Article no.: 17662000 LED converter 350 mA, on/off switchable Power: 1 - 7,2 W Dimensions: 68 mm x 35 mm x 21 mm
	Article no.: 17662010 LED converter 350 mA, on/off switchable Power: 1 - 7,2 W Dimensions: 68 mm x 35 mm x 21 mm
	Article no.: 17662020 LED converter 350 mA, on/off switchable Power: 1 - 7,2 W Dimensions: 68 mm x 35 mm x 21 mm
	Article no.: 17613000 LED converter 350 mA, on/off switchable Power: 1 - 15 W Dimensions: 115 mm x 34 mm x 19 mm
	Article no.: 17613010 LED converter 350 mA, on/off switchable Power: 1 - 15 W Dimensions: 115 mm x 34 mm x 19 mm
	Article no.: 17613020 LED converter 350 mA, on/off switchable Power: 1 - 15 W Dimensions: 115 mm x 34 mm x 19 mm
	Article no.: 17621000 LED converter 350 mA, on/off switchable Power: 1 - 21 W Dimensions: 128 mm x 50 mm x 13 mm
	Article no.: 17621010 LED converter 350 mA, on/off switchable Power: 1 - 21 W Dimensions: 128 mm x 50 mm x 13 mm
	Article no.: 17621020 LED converter 350 mA, on/off switchable Power: 1 - 21 W Dimensions: 128 mm x 50 mm x 13 mm

**RELATO LED light point**

Article no. P3605W

Light.  
For Generations.

Accessories	
	<p>Article no.: 17648000            LED converter 350 mA, trailing-edge phase dimmable            Power: 0,7 - 17 W            Dimensions: 166 mm x 46 mm x 34 mm</p>
	<p>Article no.: 17648010            LED converter 350 mA, trailing-edge phase dimmable            Power: 0,7 - 17 W            Dimensions: 166 mm x 46 mm x 34 mm</p>
	<p>Article no.: 17648020            LED converter 350 mA, trailing-edge phase dimmable            Power: 0,7 - 17 W            Dimensions: 166 mm x 46 mm x 34 mm</p>