

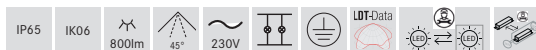
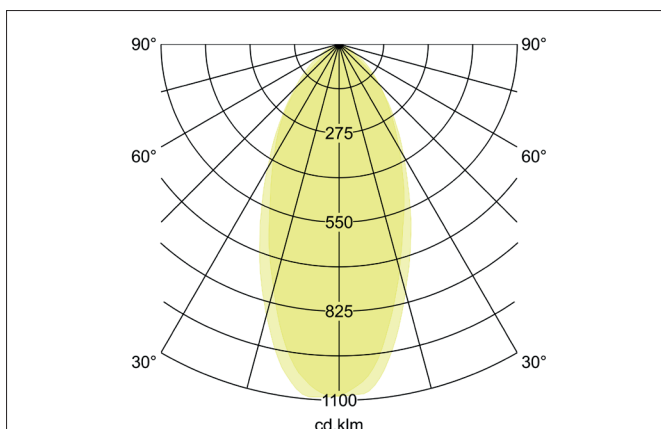
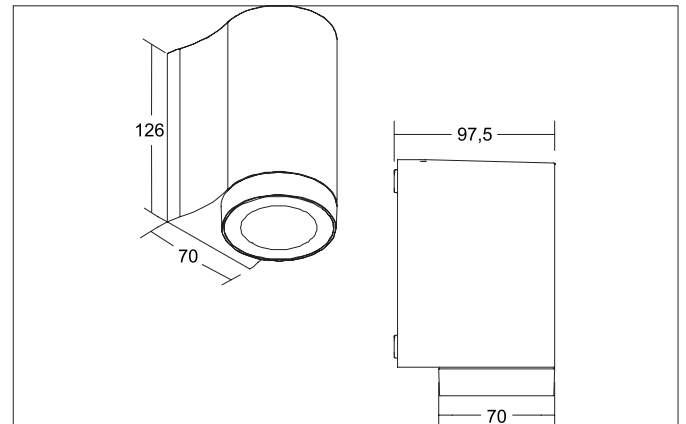

YLIP LED wall surface mounted luminaire, IP65

Article no. 10130183

Tender

oval LED surface-mounted wall light, IP65, switchable, luminaire length 140 mm, luminaire width 70 mm, height 95 mm, weight 0.77 kg, with rotationally symmetrical narrow-wide beam light distribution. Transparent glass cover, rated luminous flux 800 lm, rated wattage 1 x 8 W, light color warm white to daylight white, most similar color temperature (CCT) 3,000 - 5,700 K, general color rendering index CRI > 80, service life L70/B50 at 25 °C: 50,000 h, housing material: aluminum / glass, color: black structure, permissible ambient temperature (ta): -20 to +45 °C, protection class (EN 61140): I, degree of protection (DIN EN 60529): IP65, degree of impact resistance according to IEC62262: IK06. With electronic control gear, switchable.

Article data	
Article no.	10130183
GTIN	4251433971801
Series name	YLIP
Short description	LED wall surface mounted luminaire, IP65
Material	Aluminium / Glass
Colour	black structure
Type of surface	Structure
Shape	Oval
Length	140 mm
Width	70 mm
Height	95 mm
Scope of delivery	inkl. Konverter zum Anschluss an 230 V-Netzspannung, schaltbar
Weight	0.77 kg
Conformance	CE, UKCA

YLIP LED wall surface mounted luminaire, IP65

Article no. 10130183

Lighting technology	
Colour temperature	3.000 K / 4.000 K / 5.700 K
Light colour	white
Color Temperature 1	3,000 K
Color Temperature 2	4,000 K
Color Temperature 3	5,700 K
Light output	Direct
Luminous flux	800 lm
Luminous flux 1	670 lm
Luminous flux 2	800 lm
Luminous flux 3	700 lm
System efficiency	100 lm/W
Colour rendering	CRI > 80
Luminaire optics	Lens
Reflector	Without
Beam angle	45°
Light sharing	Symmetric
Adjustable color temperature	Stages

Operating technology of the luminaire	
System output	8 W
Voltage type	AC
AC nominal voltage max	230 V
Frequency max	50 Hz
Frequency min	50 Hz
Lamp	LED
Lamp holder	Without fitting
Protection class	I
Degree of protection	IP65
Ambient temperature	-20 bis +45 °C
Dimmable	No
Control	on/off
Bulb change possible	The light source of this luminaire may only be replaced by the manufacturer or a service technician commissioned by him or a similarly qualified person.
Rated life time L70/B50 at 25 °C	50,000 h
Energy efficiency class	nicht erforderlich

Mounting technology	
Mounting method	Surface mounting
Place of installation	Wall-mounted
Adjustability	Not adjustable
Impact resistance	IK06
Material cover	Glass transparent
Suitable for through-wiring	Yes

Packing data	
Gross weight	0.895 kg
Length of packaging	178 mm
Packaging width	105 mm
Packaging height	135 mm
Disposal at end of life	<p>This product must not be disposed of with household waste. You are obliged, to dispose of such electrical waste separately.</p> <p>By disposing of electrical waste and other old or defective electronics separately, you support recycling or other forms of re-use. In that way you help to take care and to avoid that harmful substances get into the environment.</p>