

LED wall surface mounted luminaire

Article no. 10020183

Light.
For Generations.

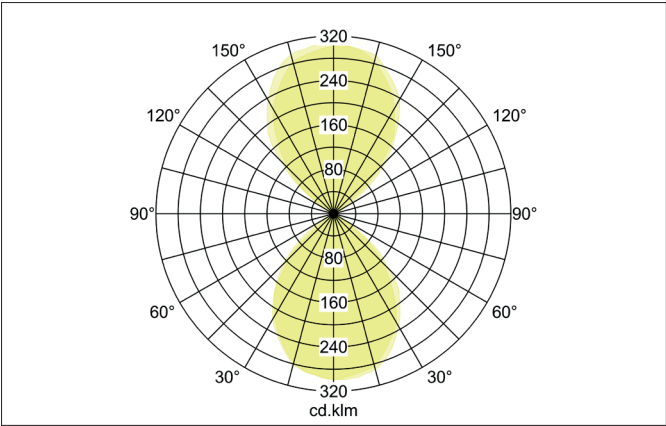
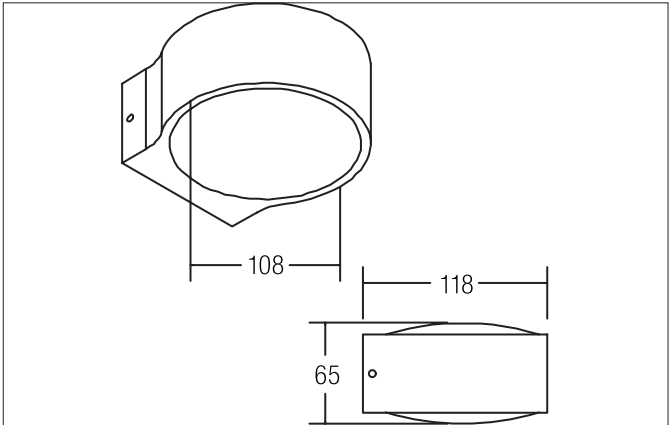

Tender
LED wall surface mounted luminaire, Round., Hight 116.0 mm Weight 1.338 kg, asymmetric optimal light distribution due to a glass transparent cover.Luminous flux 560 lm, Power 1 x 8 W, Light colour warm white, Correlated color temprature (CCT) 3.000 K, Colour rendering index CRI > 80, Housing material: Aluminium, Colour: White, Permissible ambient temperature (ta): -20 °C - +25 °C, Protection class (EN 61140): I, Degree of protection (DIN EN 60529): IP54, .With electronic driver, on/off switchable.

Article data	
Article no.	10020183
GTIN	4251433918066
Short description	LED wall surface mounted luminaire
Material	Aluminium
Colour	White
Type of surface	Matt
Shape	Round
Length	65 mm
Width	108 mm
Hight	116 mm
Weight	1.338 kg

LED wall surface mounted luminaire

Article no. 10020183

Light.
For Generations.

Lighting technology	
Colour temperature	3.000 K
Light colour	White
Light output	Direct/Indirect
Luminous flux	560 lm
System efficiency	70 lm/W
Colour rendering	CRI > 80
Reflector	Without
Beam angle	90°
Light sharing	Asymmetric
Adjustable color temperature	No

Operating technology of the luminaire	
System output	8 W
Voltage type	AC
AC nominal voltage max	220 V
Frequenz max.	50 Hz
Lamp	LED
Protection class	I
Degree of protection	IP54
Control	on/off
Bulb change possible	The light source of this luminaire may only be replaced by the manufacturer or a service technician commissioned by him or a similarly qualified person.

Mounting technology	
Mounting method	Surface mounting
Place of installation	Wall-mounted
Adjustability	Not adjustable
stamp	UKCA
Material cover	Glass transparent

Packing data	
Gross weight	1.338 kg
Length of packaging	200 mm
Packaging width	200 mm
Packaging height	180 mm
Disposal at end of life	<p>This product must not be disposed of with household waste. You are obliged, to dispose of such electrical waste separately.</p> <p>By disposing of electrical waste and other old or defective electronics separately, you support recycling or other forms of re-use. In that way you help to take care and to avoid that harmful substances get into the environment.</p>