

LED recessed spot

Article no. 12251633

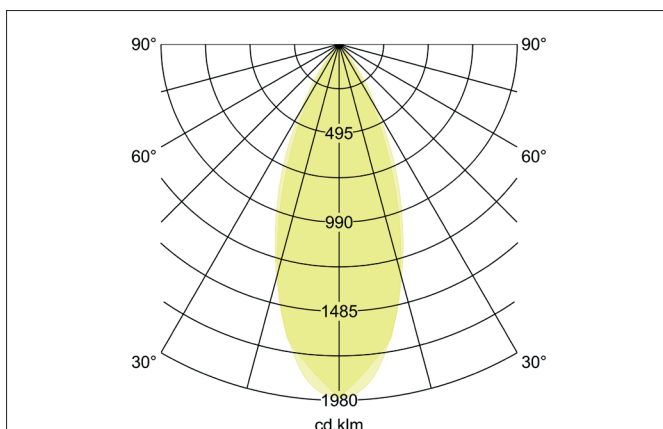
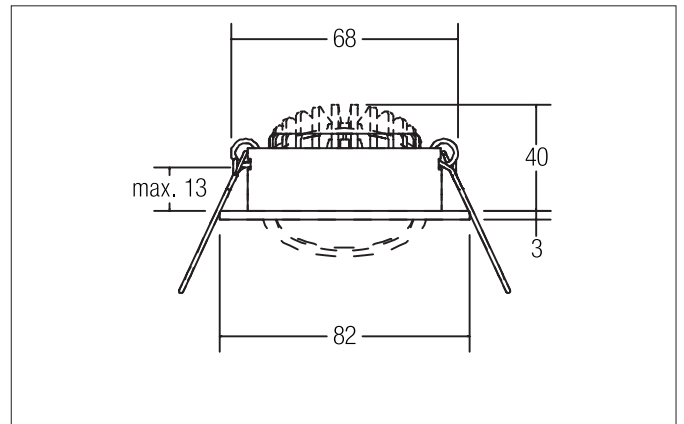
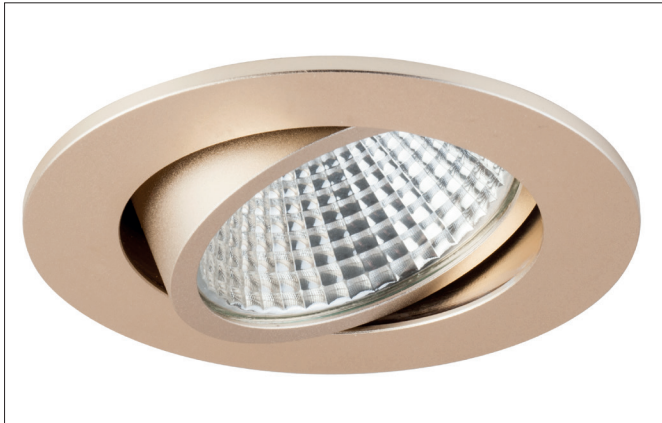

Tender

LED recessed spot, Round. Ceiling cut-out Ø 68 mm, Installation depth 40 mm, Outer diameter 82 mm, Weight 0,120 kg, with rotations-symmetrical, deep, wide distributed light intensity. Cover glass transparent. Luminous flux 290 lm, Power 1 x 3 W, Light colour warm white, Correlated color temperature (CCT) 2.700 K, Colour rendering index CRI > 80, Housing material: Aluminium, Colour: Champagne, Permissible ambient temperature (ta): -20 °C - +25 °C, Protection class (EN 61140): III, Degree of protection (DIN EN 60529): IP20. For connection to an external driver, which is not included in the scope of delivery of the luminaire. Depending on driver dimmable.

Article data	
Article no.	1225 1633
GTIN	4250047796299
Short description	LED recessed spot
Material	Aluminium
Colour	Champagne
Type of surface	Matt
Shape	Round
Outer diameter	82 mm
Built-in diameter	68 mm
Installation depth	40 mm
Weight	0.120 kg
stamp	MM
Conformance	CE, UKCA

LED recessed spot

Article no. 12251633

Lighting technology	
Colour temperature	2.700 K
Light colour	White
Light output	Direct
Luminous flux	290 lm
System efficiency	97 lm/W
Colour rendering	CRI > 80
Reflector	High-gloss
Beam angle	38°
Light sharing	Symmetric
Adjustable color temperature	No

Operating technology of the luminaire	
System output	3 W
Voltage type	DC
Current	350 mA
Lamp	LED
Lamp holder	Plug&Play
Protection class	III
Degree of protection	IP20
Control	Depending on driver
Bulb change possible	The light source of this luminaire may only be replaced by the manufacturer or a service technician commissioned by him or a similarly qualified person.

Mounting technology	
Mounting method	Recessed mounting
Place of installation	Ceiling-mounted
Adjustability	Pivoted
Swivel angle	30°
Further references	No cover with thermal insulation material
Material cover	Glass transparent

Packing data	
Gross weight	0.136 kg
Length of packaging	85 mm
Packaging width	43 mm
Packaging height	85 mm
Disposal at end of life	<p>This product must not be disposed of with household waste. You are obliged, to dispose of such electrical waste separately.</p> <p>By disposing of electrical waste and other old or defective electronics separately, you support recycling or other forms of re-use. In that way you help to take care and to avoid that harmful substances get into the environment.</p>

LED recessed spot

Article no. 12251633

Required accessories

Article no.: 17666000

LED converter 350 mA, on/off switchable

Power: 1 - 5 W, Plug&Play

Dimensions: 52 mm x 30 mm x 23 mm

https://www.brumberg.com/fileadmin/products/Datenblatt_17666000_2021_DE.pdf

Article no.: 17662020

LED converter 350 mA, on/off switchable

Power: 1 - 7,2 W, Plug&Play + Anschlussbox

Dimensions: 68 mm x 35 mm x 21 mm

https://www.brumberg.com/fileadmin/products/Datenblatt_17662020_2021_DE.pdf

Article no.: 17613000

LED converter 350 mA, on/off switchable

Power: 1 - 15 W, Plug&Play

Dimensions: 115 mm x 34 mm x 19 mm

https://www.brumberg.com/fileadmin/products/Datenblatt_17613000_2021_DE.pdf

Article no.: 17621020

LED converter 350 mA, on/off switchable

Power: 1 - 21 W, Plug&Play + Anschlussbox

Dimensions: 128 mm x 50 mm x 13 mm

https://www.brumberg.com/fileadmin/products/Datenblatt_17621020_2021_DE.pdf

Article no.: 17663020

LED converter 350 mA, trailing-edge phase dimmable

Power: 2,8 - 7 W, Plug&Play + Anschlussbox

Dimensions: 110 mm x 50 mm x 19 mm

https://www.brumberg.com/fileadmin/products/Datenblatt_17663020_2021_DE.pdf

Article no.: 17648020

LED converter 350 mA, trailing-edge phase dimmable

Power: 0,7 - 17 W, Plug&Play + Anschlussbox

Dimensions: 166 mm x 46 mm x 34 mm

https://www.brumberg.com/fileadmin/products/Datenblatt_17648020_2021_DE.pdf