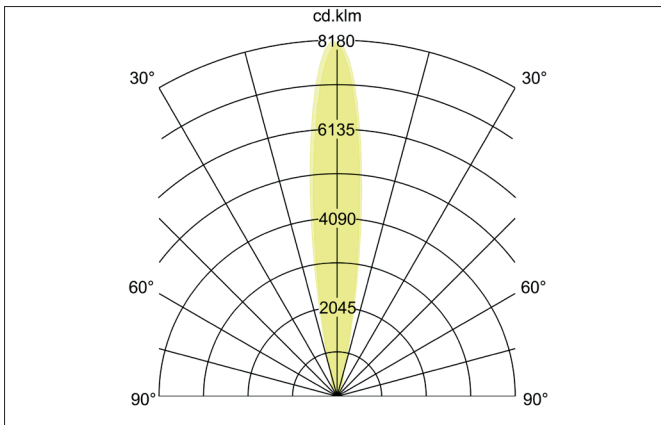
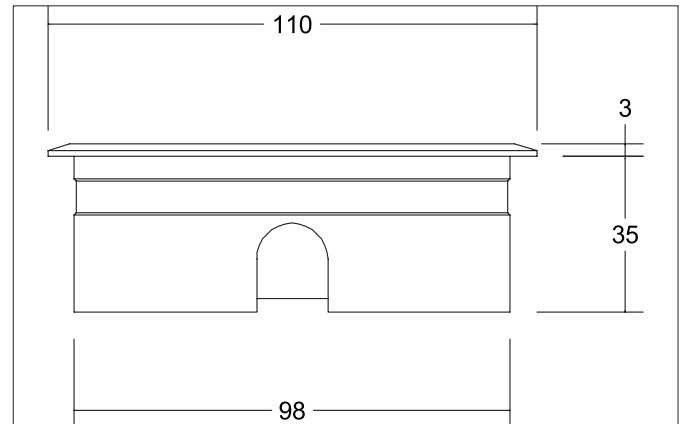

**HYBRIDE FLAT LED-floor recessed light, V4A, IP67**

Article no. 14037223

**Tender**

LED-floor recessed light, V4A, IP67, Round. Ceiling cut-out Ø 98 mm, Installation depth 35 mm, Outer diameter 110 mm, Weight 0,631 kg, with rotationssymmetrical, deep, wide distributed light intensity. Cover glass transparent. Luminous flux 420 lm, Power 1 x 6 W, Light colour warm white, Correlated color temprature (CCT) 3.000 K, Colour rendering index CRI > 80, Housing material: Stainless steel V4A / Aluminium / Glass, Colour: Stainless steel, Permissible ambient temperature (ta): -20 °C - +25 °C, Protection class (EN 61140): III, Degree of protection (DIN EN 60529): IP67, shock resistance according to IEC62262: IK08 .For connection to an external driver, which is not included in the scope of delivery of the luminaire. on/off switchable.

Article data	
Article no.	14037223
GTIN	4251433926245
Series name	HYBRIDE FLAT
Short description	LED-floor recessed light, V4A, IP67
Material	Stainless steel V4A / Aluminium / Glass
Colour	Stainless steel
Shape	Round
Outer diameter	110 mm
Built-in diameter	98 mm
Installation depth	35 mm
Scope of delivery	incl. aquastop and ceiling mounting springs
Weight	0.631 kg
Length of the connection line	1,000 mm
Conformance	CE, UKCA

**HYBRIDE FLAT LED-floor recessed light, V4A, IP67**

Article no. 14037223

Lighting technology	
Colour temperature	3.000 K
Light colour	White
Luminous flux	420 lm
System efficiency	70 lm/W
Colour rendering	CRI > 80
Beam angle	20°
Light sharing	Symmetric
Adjustable color temperature	No

Operating technology of the luminaire	
System output	6 W
Voltage type	DC
Lamp	LED
Lamp holder	Without fitting
Protection class	III
Degree of protection	IP67
Dimmable	No
Control	on/off
Length of the connection line	1,000 mm
Design of the connecting cable	lateral
Bulb change possible	The light source of this luminaire may only be replaced by the manufacturer or a service technician commissioned by him or a similarly qualified person.

Mounting technology	
Mounting method	Recessed mounting
Place of installation	Floor-mounted
Adjustability	Not adjustable
Max. load	1,000 kg
Over rollable	No
Impact resistance	IK08
Further references	V4A
Material cover	Glass transparent

Packing data	
Gross weight	0.694 kg
Length of packaging	120 mm
Packaging width	120 mm
Packaging height	55 mm
Disposal at end of life	This product must not be disposed of with household waste. You are obliged, to dispose of such electrical waste separately. By disposing of electrical waste and other old or defective electronics separately, you support recycling or other forms of re-use. In that way you help to take care and to avoid that harmful substances get into the environment.

**HYBRIDE FLAT LED-floor recessed light, V4A, IP67**

Article no. 14037223

**Required accessories**

Article no.: 17207000

LED power supply 24 V DC, on/off switchable

Power: 1 - 30 W

Dimensions: 160 mm x 50 mm x 22 mm

[https://www.brumberg.com/fileadmin/products/Datenblatt\\_17207000\\_2021\\_DE.pdf](https://www.brumberg.com/fileadmin/products/Datenblatt_17207000_2021_DE.pdf)

Article no.: 17206000

LED power supply 24 V DC, 1-10 V dimmable (analog)

Power: 1 - 20 W

Dimensions: 145 mm x 55 mm x 19 mm

[https://www.brumberg.com/fileadmin/products/Datenblatt\\_17206000\\_2021\\_DE.pdf](https://www.brumberg.com/fileadmin/products/Datenblatt_17206000_2021_DE.pdf)

Article no.: 17206001

LED power supply 24 V DC, 1-10 V dimmable (analog)

Power: 1 - 20 W

Dimensions: 146 mm x 55 mm x 19 mm

[https://www.brumberg.com/fileadmin/products/Datenblatt\\_17206001\\_2021\\_DE.pdf](https://www.brumberg.com/fileadmin/products/Datenblatt_17206001_2021_DE.pdf)