

# NINA 30M SELFTEST E3 LIFEPO4



- EN** Installation Instructions
- DE** Montageanleitung
- CZ** Montážní návod
- DK** Monteringsvejledning
- EE** Paigaldusjuhend
- FI** Asennusohje
- FR** Notice de montage
- HU** Szerelési útmutató
- HR** Uputstvo za montažu
- NL** Montagehandleiding
- RO** Instructuni de montaj

- IT** Istruzioni di montaggio
- LT** Montavimo Instrukcijos
- LV** Instalācijas instrukcija
- NO** Monteringsanvisning
- PL** Instrukcja montażu
- SE** Installationsanvisning
- RU** Инструкция по монтажу
- SRB** Instrukcija za instalaciju
- SK** Montážny návod
- SLO** Navodilo za montažo
- CN** 安装说明书



1. Installation and commissioning may only be carried out by authorized specialists and wired in accordance with the latest IEE electrical regulations or the national standards.
2. Mains power must be switched off before carrying out installation.
3. The manufacturer shall not be liable for any damage resulting from inappropriate modifications to the luminaire or faulty installation.



SAP Code	Product Description	Input	Wattage	Operation Temperature
96635654	NINA 30M SELFTEST E3 LIFEPO4	AC 220-240V 50-60Hz	3W	0-+40°C

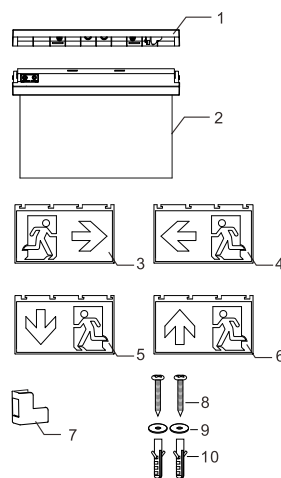

1	x1
2	x1
3	x1
4	x1
5	x2
6	x2
7	x2
8	x2
9	x2
10	x2

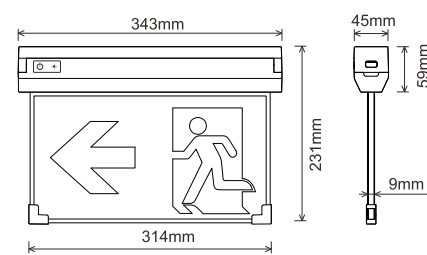

**1**

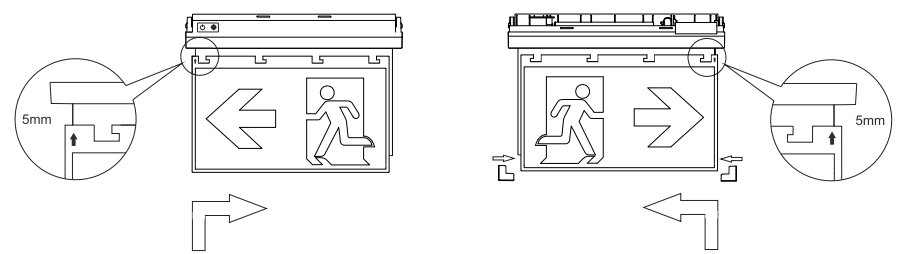

**2**

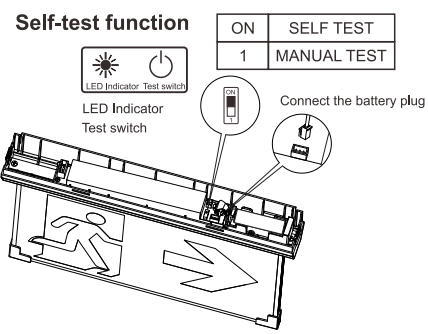

**3**

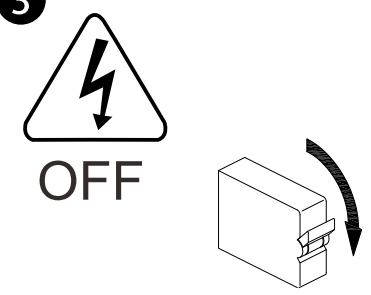

**4**

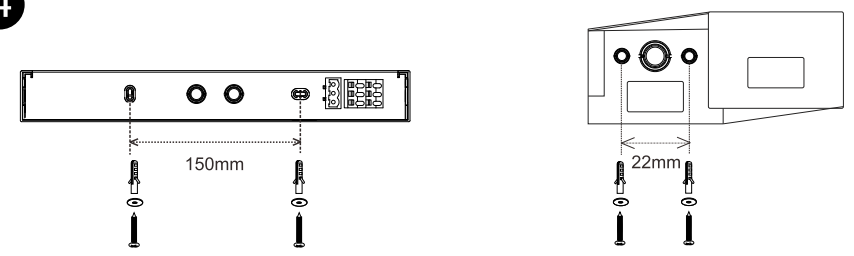

**5**

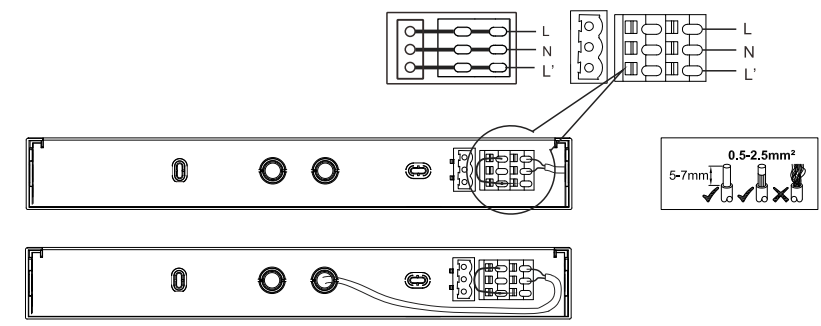

6

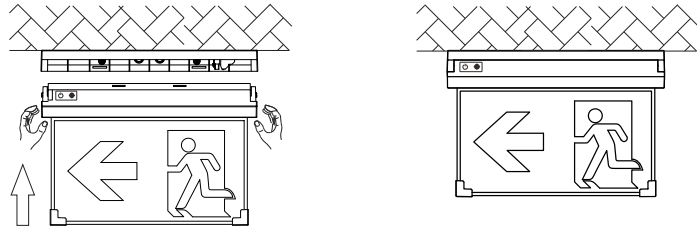

7

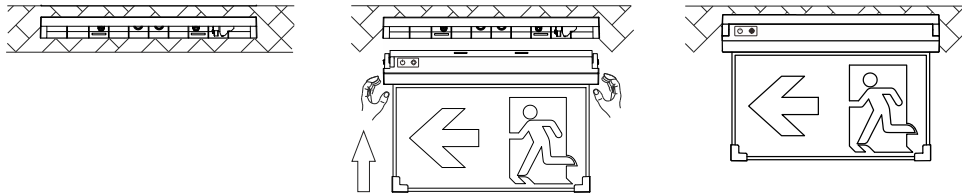

8

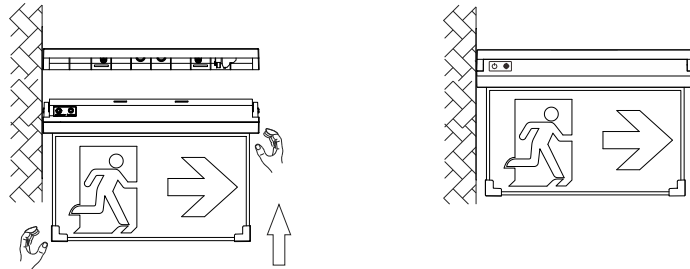

9

Fill in 4-digit code on back of the product

X	1	AF		180	
X Self-contained	0 Non-Maintained	A	Including test device (Manual Test)	180	Duration (Minutes)
	1 Maintained	F	Self-test according to IEC 61347-2-7, EL-T marked		

10

Replace the battery (Order 96635655)

A. Remove the battery and disconnect the plug

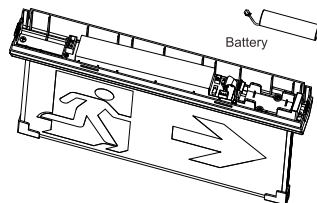

B. Mark installation date

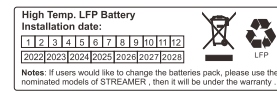

**Self-test**

The emergency kits carry out self-tests automatically to ensure its functionality. The self-test includes 3 types of tests:

**Initial test**

- As soon as mains supply is connected, the emergency kit will carry out a 3-seconds functional test automatically.
- In case of a failure, the LED will turn permanent red. Otherwise, the charge mode will start.

**Functional test**

- Refers to charging, discharging and the functioning of load.
- Carry out for 10 seconds automatically every 30 calendar days.

**Duration test**

- Refers to the test of batteries capacity.
- Carry out every 180 calendar days.

**Rest mode**

Rest mode can be initiated during emergency mode by pressing test switch longer than 3 seconds. The rest mode will be exited automatically after reconnect AC mains.

**Timer reset:**

Press test switch >15 seconds in charging mode, will reset timer for functional and duration test. Meanwhile indicator red flash once, then indicator green slowly flash 3 times, this means timer resetting is successful.

**Please note**

If mains supply is off during self-test period, emergency conversion module would terminate self-test immediately and go into emergency mode.

Self-test is under the regulation of EN62034. Yearly manual test will have no impact on battery life.

**Explanation of LED indicator**

	Color	LED indication	Status	Comment
	Green	Permanent green	Charging mode Fully Charged	AC mode
	Green	Fast flashing green (0.1 sec on, 0.1 sec off)	Function test underway	
	Green	Slow flashing green (1 sec on, 1 sec off)	Duration test underway	
	Red	Permanent red	Load failure	Open circuit/ Short circuit Led failure (emergency mode)
	Red	Slow flashing red (1 sec on, 1 sec off)	Battery failure	Battery failed the duration test or function test / No battery
		Green and red off	DC mode	Battery operation (emergency mode)

