

# ELEVATOR COVER (928.902)

Variante Einbau | Built-in version

# BACH MANN

D  
GB  
F

Übersicht  
Overview  
Vue d'ensemble

ES  
RO  
NL

Visión general  
Privire de ansamblu  
Overzicht

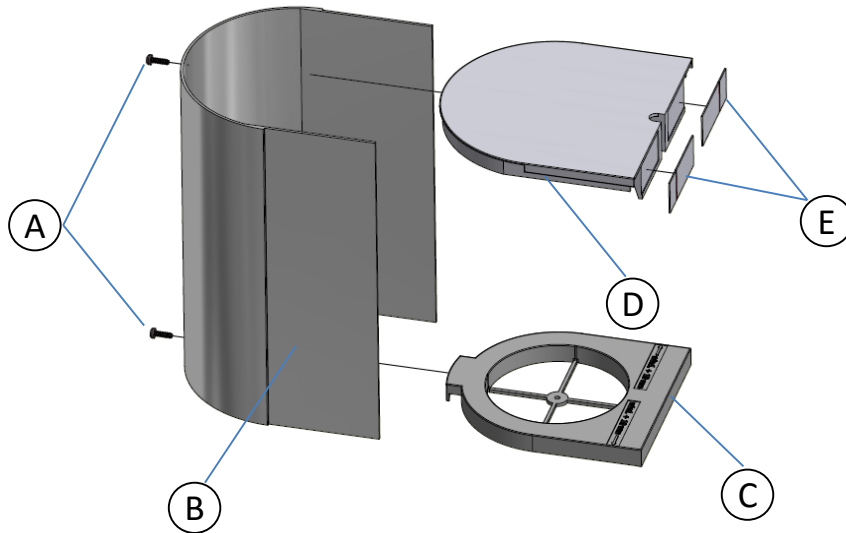

Nr.	Beschreibung	Menge	Description	Quantity
A	Gewindeschneidende Schraube 3x10	2 Stk.	Thread-cutting tapping screw 3x10	2 pcs.
B	Frontblende	1 Stk.	Front panel	1 pc.
C	Justierungsring	1 Stk.	Adjustment ring	1 pc.
D	Deckel	1 Stk.	Lid	1 pc.
E	Powerstrips 20x50	2 Stk.	Power strips 20x50	2 pcs.
Komponenten sind aus Transportgründen vormontiert. Zur Installation bitte den Justiererring (C) demontieren.			Components are pre-assembled for transportation reasons. For installation please remove the adjustment ring (C).	

# ELEVATOR COVER (928.902)

Variante Einbau | Built-in version

# BACHMANN

D  
GB  
F

Montageanleitung  
Assembly Instructions  
Instructions de montage

ES  
RO  
NL

Instrucciones montaje  
Instrucțiuni montaj  
Montagehandleiding

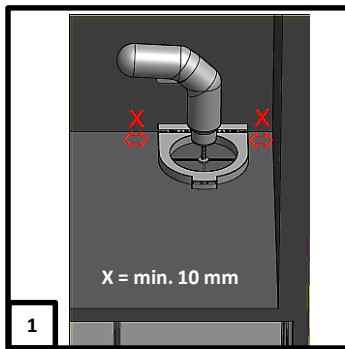

1

**Justierungsring an Wand anlegen**  
*Set up adjustment ring to the wall*

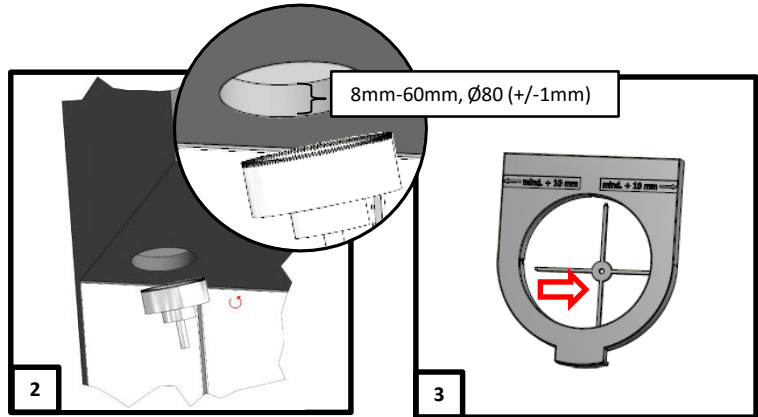

2

**Loch bohren (Vorbohren Ø 3 mm)**  
*Drill hole (Pre-drill Ø 3 mm)*

3

**Kreuz herausbrechen**  
*Lever out the cross*

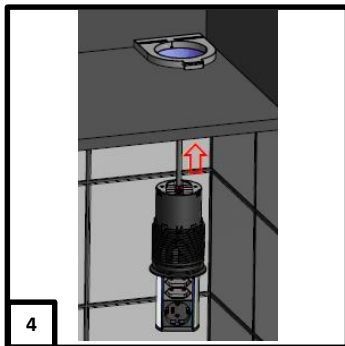

4

**Elevator von unten einsetzen**  
*(Elevator muss ausgefahren sein)*  
*Seat Elevator from below*  
*(Elevator has to be lowered)*

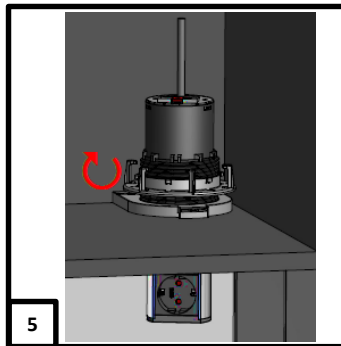

5

**Anschraubring Elevator festschrauben**  
*Tighten Elevator mounting ring*

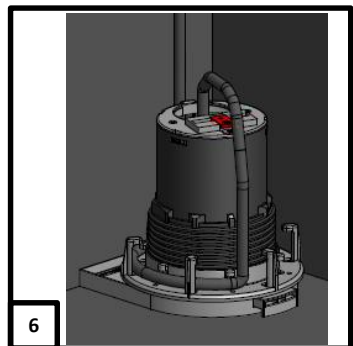

6

**Kabel in Kabelführung einfädeln**  
*(Elevator muss ausgefahren sein)*  
*Thread the cable in cable layout*  
*(Elevator has to be lowered)*

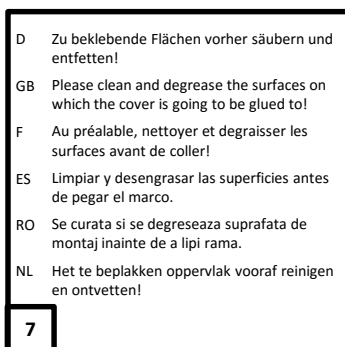

7

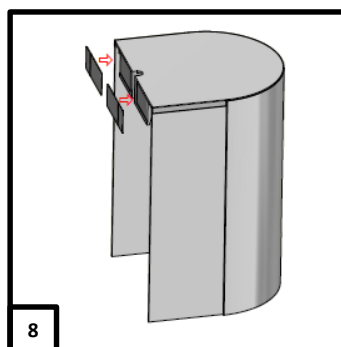

8

**Folien auf Powerstrips abziehen**  
*Remove foils on power strips*

# ELEVATOR COVER (928.902)

Variante Einbau | Built-in version

# BACHMANN

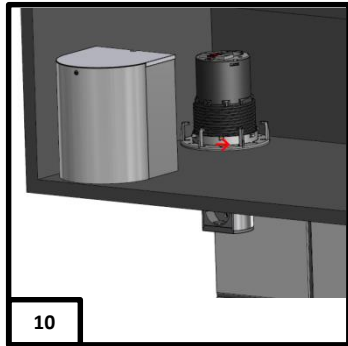

**10**  
Frontblende aufschieben  
*Stick front panel*

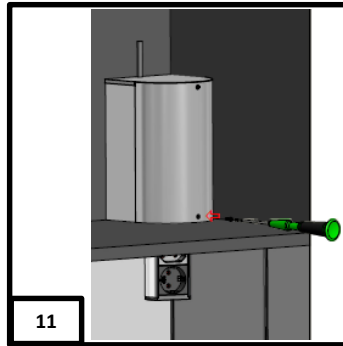

**11**  
Untere Schraube befestigen  
*Tighten lower screw*

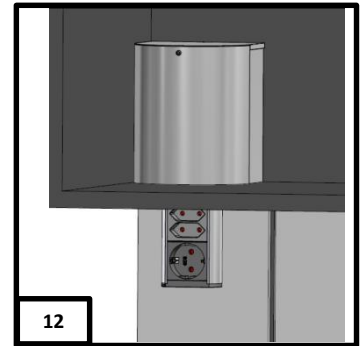

**12**



D  
GB  
F

Demontageanleitung  
Disassembly Instructions  
Instructions de démontage

ES  
RO  
NL

Instrucciones desmontaje  
Instruțiuni demontaj  
Demontagehandleiding

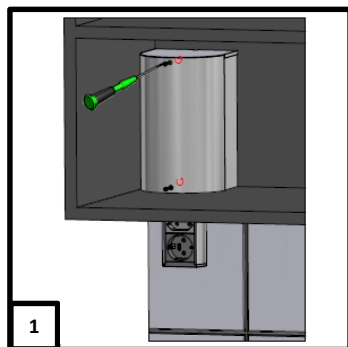

**1**  
Beide Schrauben öffnen  
*Open both screws*

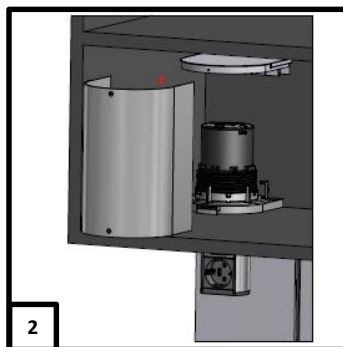

**2**  
Frontblende lösen  
*Loose front panel*

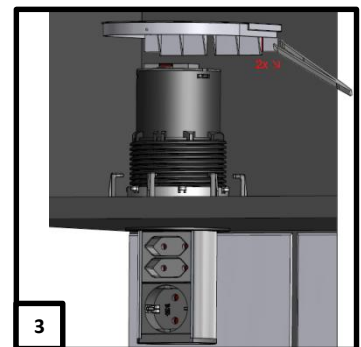

**3**  
Powerstrips seitlich abziehen  
*Remove power strips laterally*