

WEATHER SHIELD WPR12

FOR WALLBOXES eMH1 and eMH2

The weather shield WPR12 is designed for wall installation, and especially as a perfect fit for ABL's charging poles POLEMH1 and POLEMH2. The weather shield is colour coordinated with the charging poles and cable holders, blending harmoniously into the overall look of the charge point. The functional design of the WPR12 provides additional weathering protection for the wallbox.



General information

Model	Weather shield for Wallboxes eMH1 and eMH2
Product number	WPR12
EAN number	4011721185576
Commodity code	85381000
Packaging unit (PU)	1 unit
Items supplied	Weather shield, mounting kit, download notice

Construction

Type	Metal shield with pre-drilled holes and custom cut-out to fit the top part of the mounting poles POLEMH1/2
Fixing type	Screw mounted to a wall, or to a charging pole POLEMH1 or POLEMH2, using the screws included
Material	Passivated and base coated sheet metal (material: DC01)
Housing colour	Fine-textured, RAL 9011 satin
Product dimensions (H x W x D)	142 x 395 x 225 mm
Packaging dimensions (H x W x D)	400 x 230 x 150 mm
Weight (net)	approx. 2.68 kg
Weight (net)	approx. 3.5 kg

Dimensioned drawing

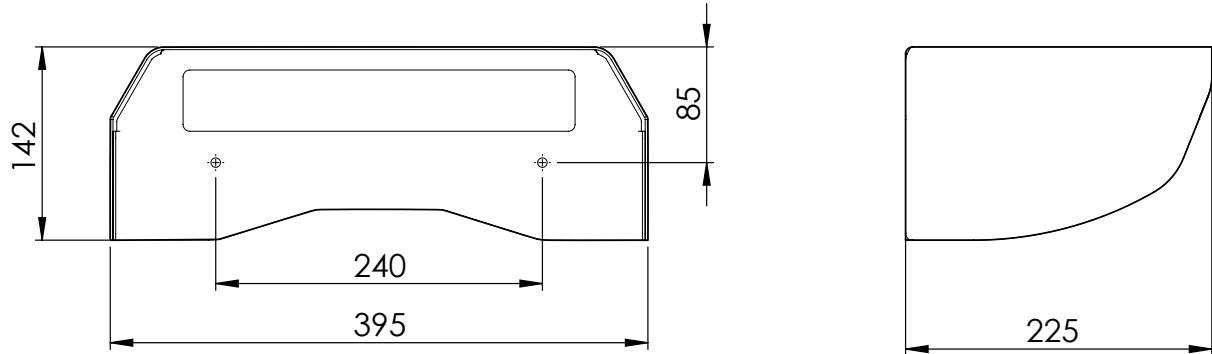

Subject to change: All performance characteristics, technical and other specifications are subject to change without prior notice.