

X2/3A1300

Art.-Nr. 131236

Specifications of single cell

Nominal voltage		1.2 V		
Capacity		0.2 C Discharge	10 C Discharge	
	Minimum	270 min	4.7 min	
	Typical	280 min	5.1 min	
Dimensions		mm		
	Diameter	17.0 ^{-0.7}		
	Height	28.5 ^{-1.0}		
Weight (approximately)		Gram		
		20		
Internal Impedance at 1000 Hz		10 mΩ (max) (After Charge)		
Charge	Standard	130 mA (0.1 C) x 15 hrs		
	Rapid	130 mA (0.1 C) x 1.05 hrs		
Ambient temperature	Charge	°C		
		Standard	0°C to 45°C	
		Rapid	0°C to 40°C	
	Discharge		-20°C to 50°C	
	Storage		-20°C to 40°C	

PVC (dimensions with tube) (mm)

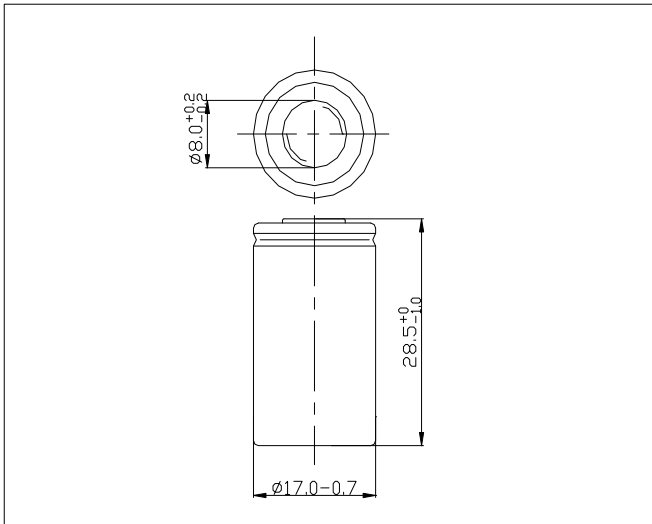

Typical characteristics

Standard charge characteristics

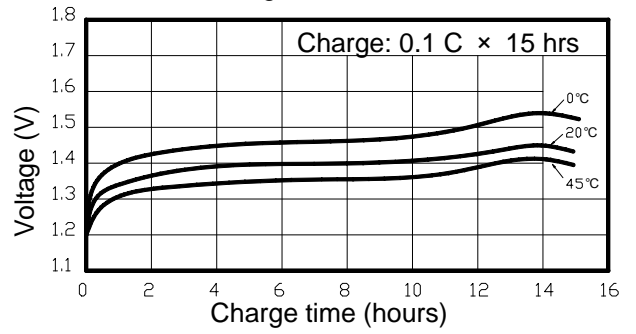

Rapid charge characteristics

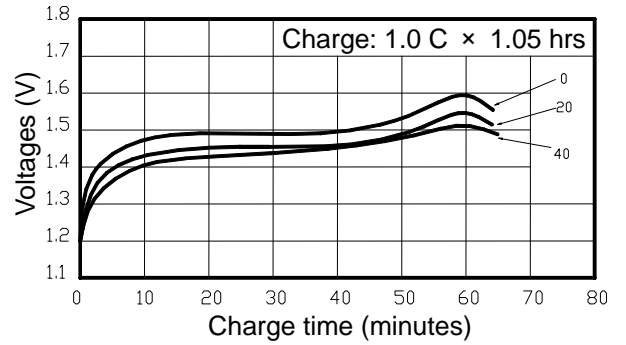

Discharge characteristics

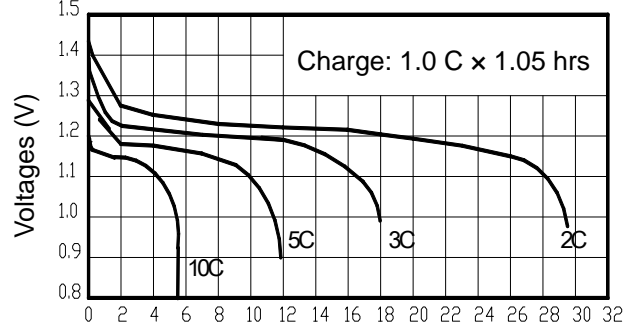

MPV(⟨V⟩) Discharge capacity (min)

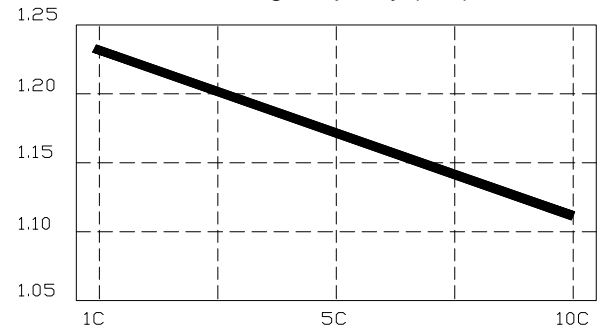

Charge retention curves of Ni-MH cylindrical cell at various storage temperature

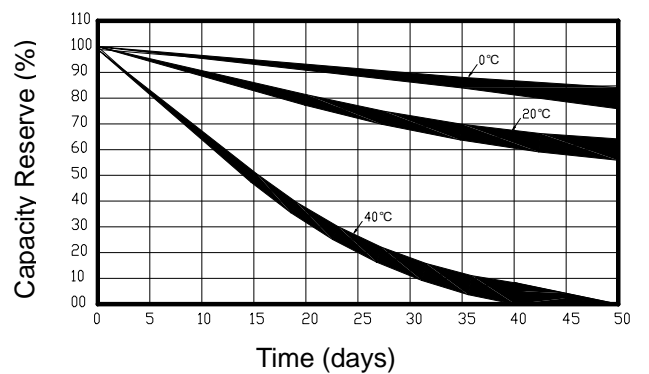

Note:

1. Nominal capacity, rated at 0.2 C 20°C.
2. Average capacity, for reference only.
3. Weight and internal impedance are for reference.
4. Standard according as IEC of test cycle life.