

ADAPTER MS (NPT/metr.)

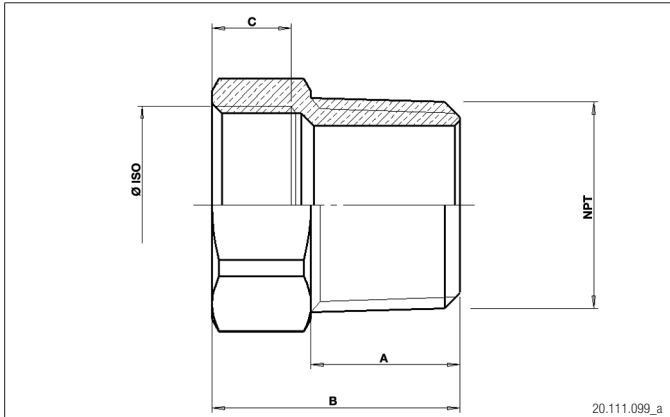

MAT

Messing vernickelt
Laiton nickelé
Nickel plated brass

RoHS

TEMP

-40°C – +200°C

Adapter MS NPT/metr.





Aussengewinde NPT, Innengewinde metrisch. Ohne O-Ring.

Adaptateur MS NPT/metr.

Filetage mâle NPT, filetage femelle metrique. Sans joint torique.

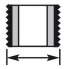
Adapter MS NPT/metr.

Male thread NPT, female thread metric. Without O-ring.

		A mm	B mm	C mm			Plica-Nr.	E-Nr.	VE
NPT 3/8"	M16	15	25	7.5	20	vernickelt	92.6413.816		50
	M20	15	26	7.5	23	vernickelt	92.6413.820		50
	M25	15	27	8.5	28	vernickelt	92.6413.825		20
NPT 1/2"	M16	20	30	8	23	vernickelt	92.6411.216		50
	M20	20	30	7.5	23	vernickelt	92.6411.220		20
	M25	20	32	8.5	28	vernickelt	92.6411.225		20
NPT 3/4"	M16	20	24	8.5	28	vernickelt	92.6413.416		50
	M20	20	24	8.5	28	vernickelt	92.6413.420		20
	M25	20	30	8.5	28	vernickelt	92.6413.425		20
	M32	20	33	9	36	vernickelt	92.6413.432		20
NPT 1"	M20	25	31	9	36	vernickelt	92.6411.020		20
	M25	25	31	9	36	vernickelt	92.6411.025		10
	M32	25	37	9	36	vernickelt	92.6411.032		10
NPT 1" 1/4	M40	25	38	9	46	vernickelt	92.6411.040		10
	M25	25	36	9	46	vernickelt	92.6411.425		10
	M32	25	36	9	46	vernickelt	92.6411.432		10
NPT 1" 1/2	M40	25	38	9	46	vernickelt	92.6411.440		10
	M40	26	37	9	52	vernickelt	92.6411.140		10
	M50	26	40	10	55	vernickelt	92.6411.150		5
NPT 2"	M63	26	41	11	70	vernickelt	92.6411.163		5
	M50	27	38	11	65	vernickelt	92.6412.050		5
	M63	27	42	11	70	vernickelt	92.6412.063		5

