

Montageanleitung

Ⓒ mounting instruction Ⓕ Notice de montage Ⓒ Instrukcja montażu
Ⓔ Instrucciones de montaje ⓘ Istruzioni di montaggio

VLBKK, VLG-FK,
VLG-FSK, VLGF.-K,
VL1G.-K

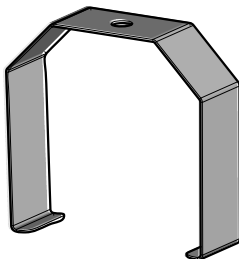

RIDI Leuchten GmbH
Hauptstrasse 31 - 33 · D-72417 Jungingen
Tel. 07477/872-0 · Fax 07477/872-48
kontakt@ridi.de · www.ridi.de



- Ⓓ Für die Installation und für den Betrieb der Leuchten sind die nationalen Sicherheitsvorschriften zu beachten.
- ⒼⒹ Please note national safety instructions for installation and operation of this luminaire.
- Ⓕ Pour l'installation et le fonctionnement des luminaires il est impératif de respecter les normes nationales de sécurité en vigueur.
- Ⓗ W celu prawidłowej instalacji i poprawnego działania oprawy należy przestrzegać krajowych przepisów bezpieczeństwa.
- Ⓔ Para la instalación y la puesta en funcionamiento de las luminarias deben observarse las normas nacionales de seguridad.
- Ⓘ Per l'installazione e il funzionamento delle lampade si fa riferimento alle normative di sicurezza nazionali.

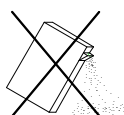
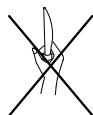
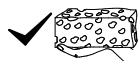

- | | | |
|---|---------|--|
| Ⓐ | VLBKK | |
| Ⓑ | VLG-FK | |
| Ⓒ | VLG-FSK | |
| Ⓓ | VLGF.-K | |
| Ⓔ | VL1G.-K | |

A

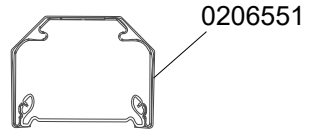
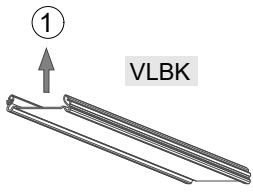

B

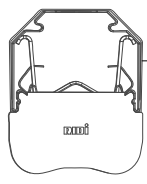
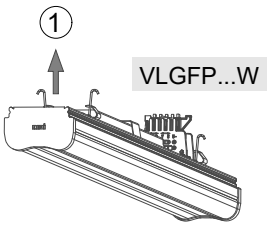
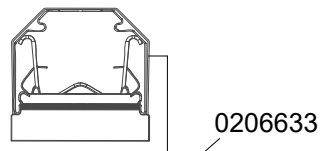
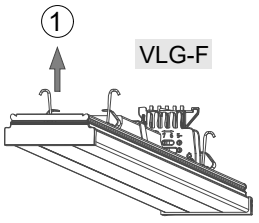

C

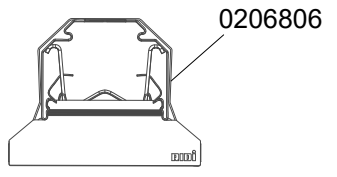
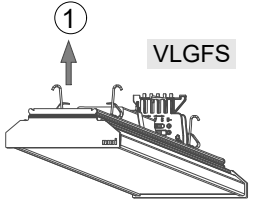

D

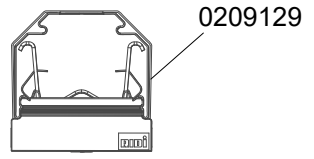
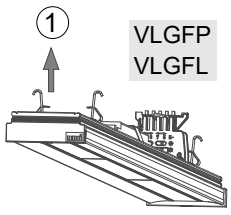

E

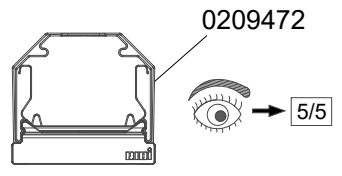
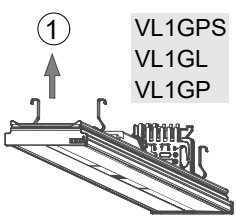

L=500mm - 3000mm **VLTM + 2x VL...K**

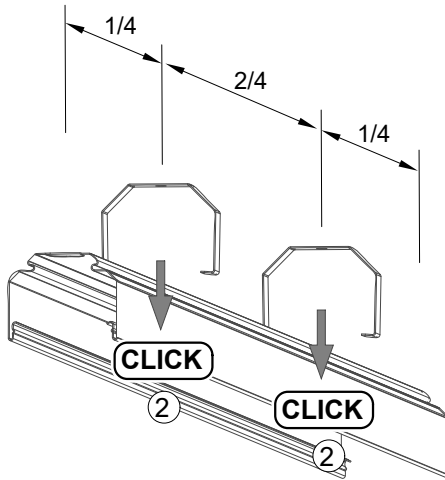

L=3000mm - 4500mm **VLTM + 3x VL...K**

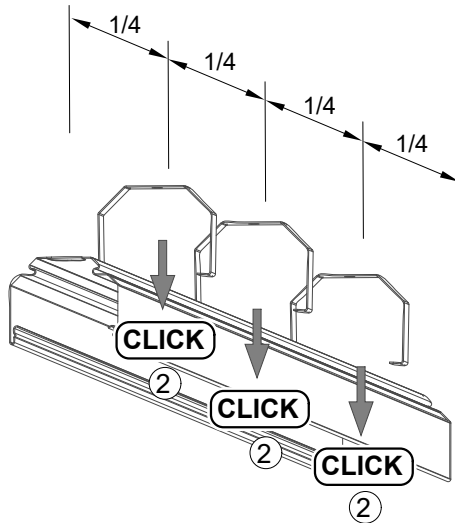

E

VL1GPS1486... L=1486mm
VL1GPS1537... L=1537mm

