

OBT PLICA-TEC (metr. + PG)

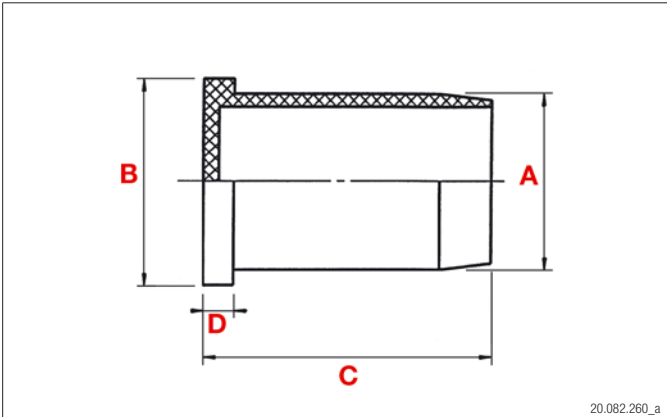

MAT	Polyethylen Polyéthylène Polyethylene
TEMP	-40°C bis +80°C -40°C à +80°C -40°C to +80°C

Stopfen PLICA-TEC

Zum Verschliessen einer nicht gebrauchten Verschraubung.

Obturateur PLICA-TEC

Pour fermer un presse-étoupe non utilisé.

Plug PLICA-TEC

To plug a cable-gland out of function.

NORM metr.	NORM PG	A mm	B mm	C mm	D mm			Plica-Nr.	E-Nr.	VE
M12	PG7	6	8	22.0	2.0			93.5346.007		50
M16	PG9	8	12	18.0	2.5			93.5346.009		50
	PG11	10	16	18.0	3.0			93.5346.011		50
M20	PG13.5	12	18	12.5	3.0			93.5346.013		50
	PG16	14	20	23.0	2.0			93.5346.016		50
M25	PG21	17	20	28.0	3.0			93.5346.021		20
M32	PG29	24	28	31.5	2.0			93.5346.029		20
M40	PG36	30	33	22.0	3.0			93.5346.036		10
M50	PG42	39	47	23.5	2.5			93.5346.042		5
M63	PG48	45	50	21.5	2.5			93.5346.048		5