

panel mounting socket outlet, straight - flange 75x75,
fixing centers 60x60



Product description	
BALS-Prd.-Nr	1320021
EAN	4024941379502
Product category	Panel mounting socket outlet INNOLINQ QUICK-CONNECT straight
Current	32A
Number of poles	5p
Arrangement of phases	3p+N+PE
Position of earth contact	6 h
Voltage	200/346 - 240/415V~

Product description	
Frequency	50/60Hz
Protection degree	IP54
Colour code	red RAL 3000
Colour of appliance	Hinged lid red RAL 3000, Enclosure grey RAL 7035
Connection design	screwless spring terminals with KONTEX-ULTRA contact
Maximum conductor size	10,0 qmm
Cable entry	other
Height	105mm
Width	75.5mm
Depth	108mm
Flange size vertical in mm	75mm
Flange size horizontal in mm	75mm
Drill hole dist. vertical mm	60mm
Drill hole dist. horizontal mm	60mm
Material of enclosure	Polyamide
Contacts	The contact carrier is made of polyamide, The contacts are brass, The contact carrier is made of high temperature resistant material

Additional technical properties	
	This product is without any lead

Logistics data	
Weight/pcs	0.215 kg / Piece
Packaging	Bag
Content amount	1 ST
EAN	4024941379502
Length	108 mm
Width	75.5 mm
Height	105 mm
Weight	0.216 kg
Volume	856.17 ccm
Packaging	Carton
Content amount	10 ST
EAN	4024941383462
Length	258 mm
Width	183 mm
Height	212 mm
Weight	2.302 kg
Volume	8,750 ccm

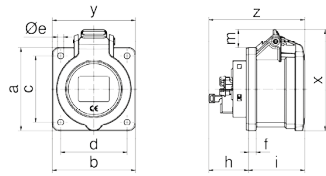

Einbauöffnung



4MB502

Ampere Poles	16 3	16 5	32 3	32 4	32 5
a	75,0	75,0	75,0	75,0	75,0
b	75,0	75,0	75,0	75,0	75,0
c	60,0	60,0	60,0	60,0	60,0
d	60,0	60,0	60,0	60,0	60,0
Øe	5,5	5,5	5,5	5,5	5,5
f	7,0	7,0	7,0	7,0	7,0
h	36,0	36,0	46,0	46,0	46,0
i	50,0	51,0	61,0	61,0	62,0
Øl	45,0	55,0	60,0	60,0	60,0
m	8,0	16,5	17,0	17,0	23,5
x	83,0	92,0	84,0	84,0	105,0
y	75,0	75,0	75,0	75,0	75,5
z	86,0	87,0	106,0	106,0	108,0

