

LED surface mounted tube luminaire

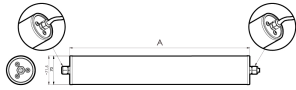

Product-Nr.	115110-03
EAN:	4260556624747
Model:	INROLED_70 mit PC Schutzrohr
Order number:	115110-03
Model:	INROLED_70 mit PC Schutzrohr
Type:	LED surface mounted tube luminaire
Illuminant:	SMD LED
Power consumption:	~11 W
Lamp luminous flux:	1670 lm
Lamp luminous efficiency:	~155 lm/W
Light distribution:	direct
Light colour:	5600K 3-step MacAdam
Connected load:	24V DC \pm 10%
Connection (connector):	Cable entry, internal clamp
Degree of protection:	IP67/IP69K
Class of protection:	III
Glare control:	opal white
Beam angle (optics):	125°
Operating temperature:	-10 °C -> +45 °C (14 °F -> 113 °F)
Colour rendering (Ra):	>85
Lamps lifetime:	> 100.000h (L80/B10)
Housing material:	aluminium inside
Cover material:	polycarbonate, shatterproof
Height [B] x Width [C]:	Ø 70 mm (~2,76")
Length [A]:	513 mm (~20,2")
Weight (net):	1200 g (~42 oz)
Gross weight:	1850 g (~65 oz)
Risk group (DIN EN 62471):	free group
Markings:	CE, UKCA
Dimmable:	optional via accessories
Mounting accessories:	optional
Made in:	Germany
Feature:	cascadable (max. 4.0 A)
cascadable:	yes