

WIDE / SLIM MPL / SLIM MGR

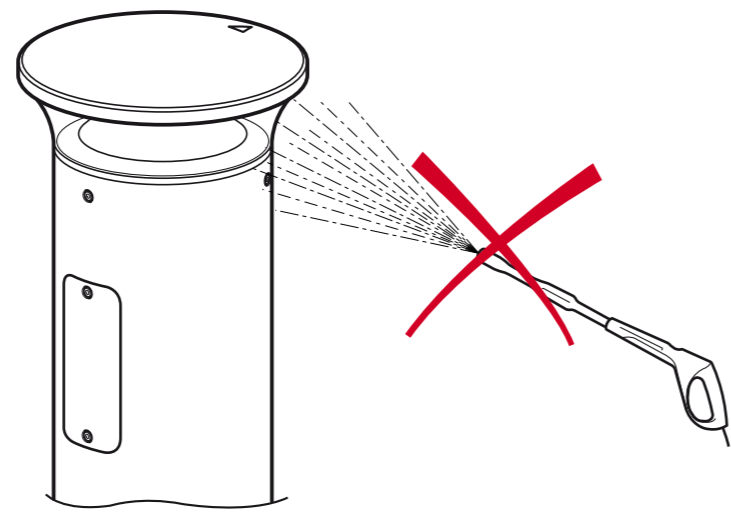
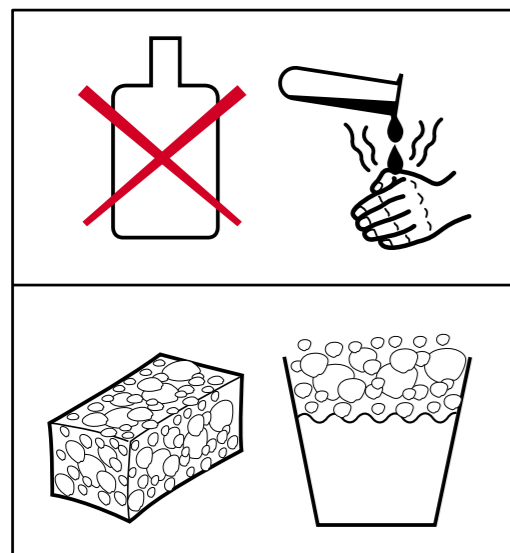
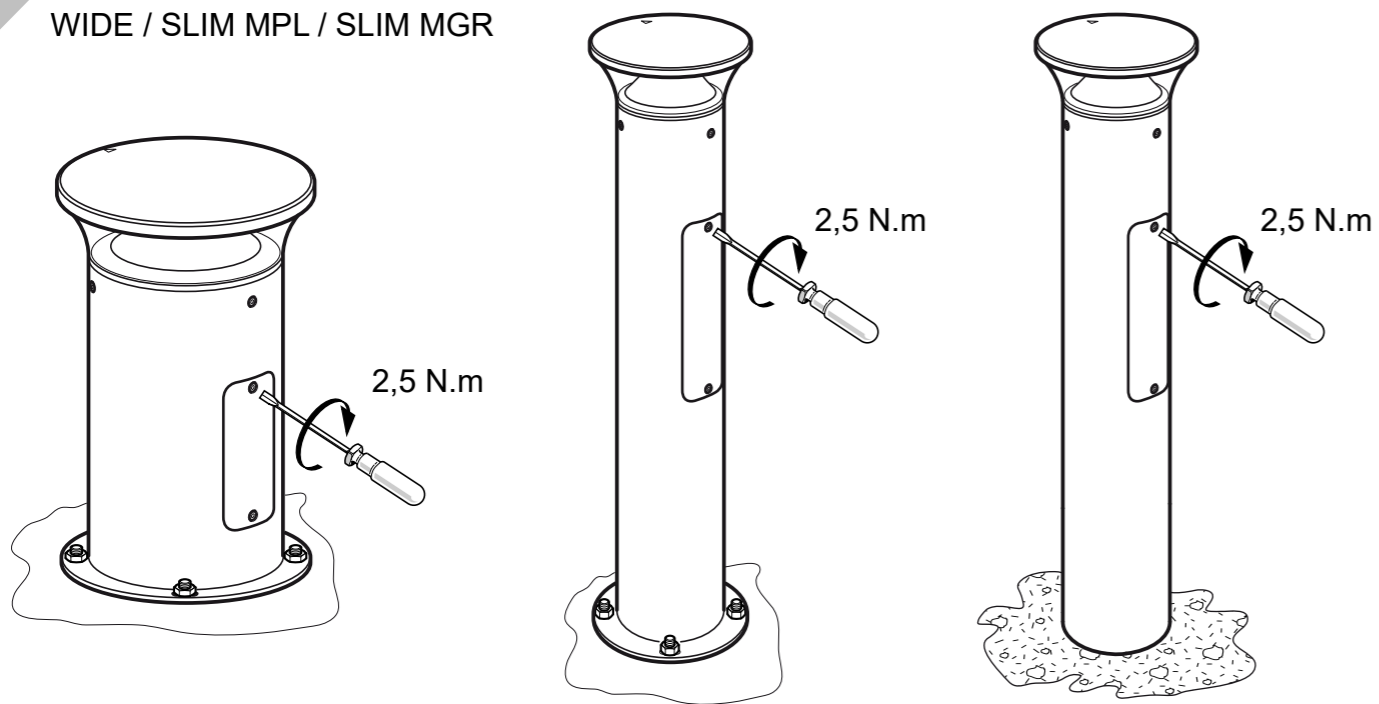

THOR BOLLARD

THORN

- UK Installation instructions
- DE Montageanleitung
- CZ Montážní návod
- DK Monteringsvejledning
- EE Paigaldusjuhend

- FI Asennusohje
- FR Notice de montage
- HU Szerelési útmutató
- IT Istruzioni di montaggio
- LT Montavimo Instrukcijos

- LV Instalācijas instrukcija
- NO Monteringsanvisning
- PL Instrukcja montażu
- SE Installationsanvisning
- RU ИНСТРУКЦИЯ ПО МОНТАЖУ

TYPE : THOR BOLLARD WIDE
THOR BOLLARD SLIM MPL
THOR BOLLARD SLIM MGR

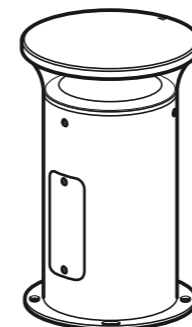

WIDE

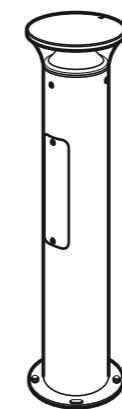

SLIM MPL

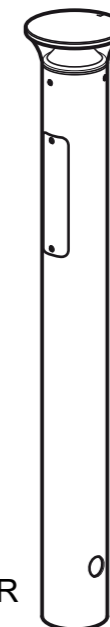

SLIM MGR

La source lumineuse contenue dans ce luminaire ne doit être remplacée que par le fabricant ou son agent de maintenance ou une personne de qualification équivalente.

The light source contained in this luminaire shall only be replaced by the manufacturer or his service agent or a similar qualified person

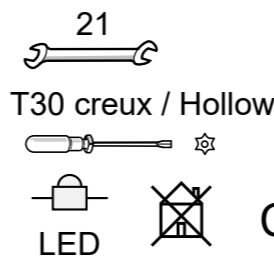

Caution, risk of electric shock
Danger, risque de chocs électriques

LED CLASS I CLASS II IK10 IP66 CE

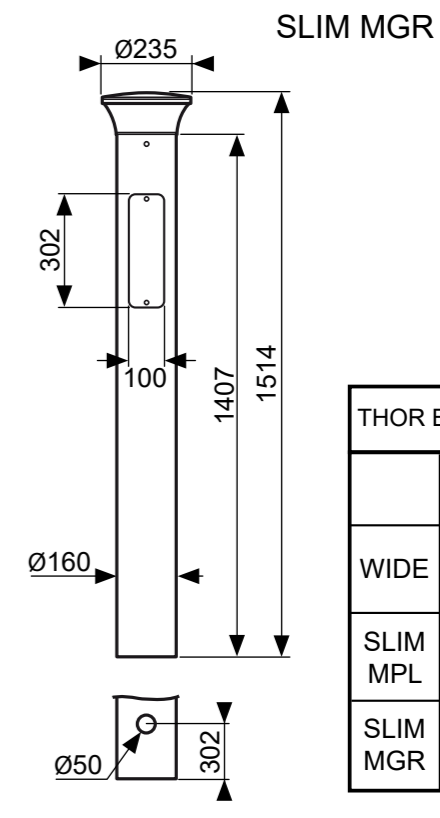
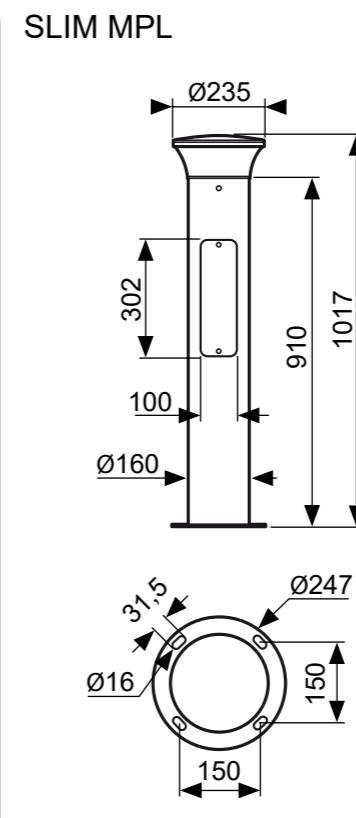
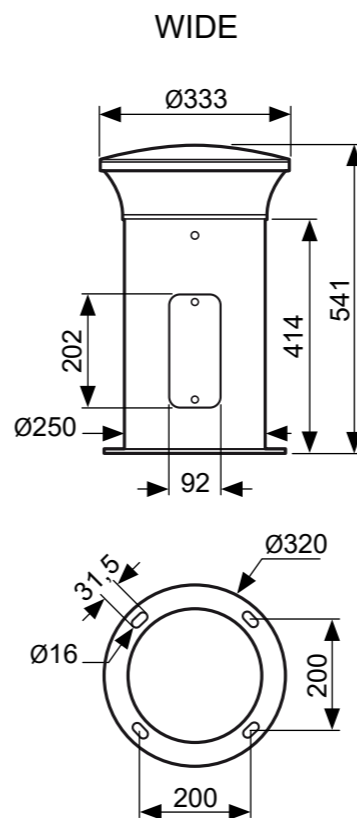

THOR BOLLARD	
	(kg)
WIDE	9.0
SLIM MPL	7.7
SLIM MGR	9.3

