

Abisoliermaße *stripping instruction*

①

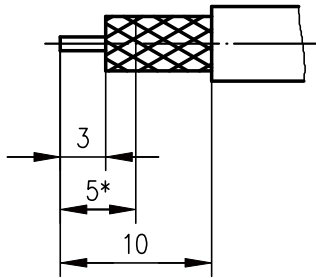

②

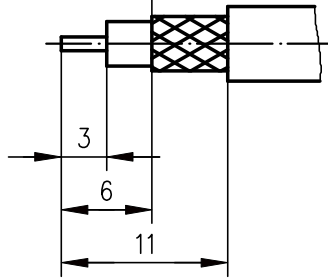

③

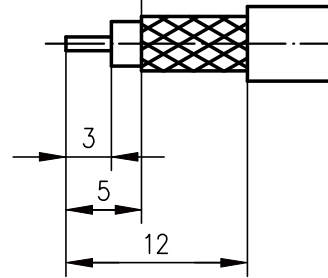

Folie bündig mit Geflecht*
*foil even with braid**

Folie bündig mit Geflecht*
*foil even with braid**

Kontaktstift *contact pin*

Crimpbereich
crimp area

Crimprohr *crimp ferrule*

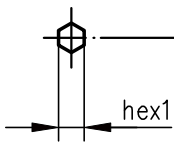

Kontaktbuchse *contact socket*

Crimpbereich
crimp area

* nur für Kabel mit Folie
only for cables with foil

Gehäuse *housing*

Crimpbereich
crimp area

Abschirmung *braid*
Folie in den Crimpanschluß schieben*
*foil goes inside housing**

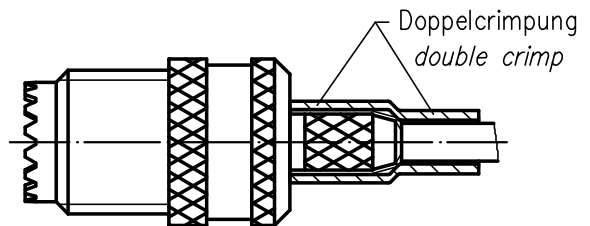
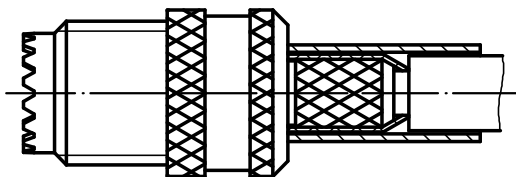
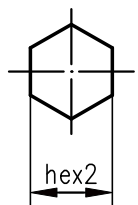

Doppelcrimpung
double crimp

XX	Crimpeinsatz <i>crimp insert</i>	6kt.1 x Länge <i>hex1 x length</i>	6kt.2 x Länge <i>hex2 x length</i>	Abisoliermaße <i>stripping instruction</i>	
05	N01003A0005	1.69x2.5	5.41x8	① Stecker <i>plug</i> ③ Buchse <i>jack</i>	
24	N01003A0023	1.25x2.5	3.25x8	②	

k	25014	11.09.13	GB
j	23387	28.11.11	MA
i	12656	06.07.01	MA
h	12401	14.03.01	BJ
Index <i>index</i>	Änderung <i>modification</i>	Datum <i>date</i>	Name <i>name</i>

	Datum <i>date</i>	Name <i>name</i>
Gez. <i>drawn</i>	20.10.92	JB
Gepr. <i>app'd</i>	25.11.91	MaH

**Series Mini UHF crimp
Serie Mini UHF crimp**

Unterr.-
Art **R** TG-Nr.
T00100B1300



Original **A4** Blatt **1/1**
sheet

Maßstab
scale **2:1**

Ersatz für/replacement for
Zeichnung vom 25.11.91