

## D-D4500H Specifications

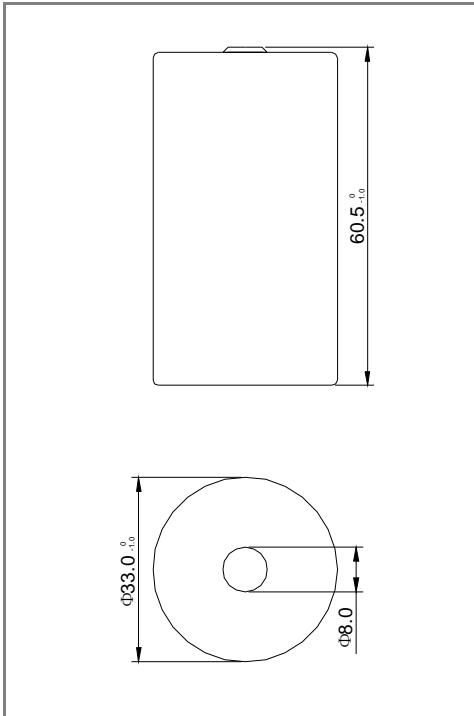

<b>Nominal Capacity</b>	<b>4500mAh</b>
<b>Nominal Voltage</b>	<b>1.2V</b>
<b>Internal Impedance (at 1000Hz)</b>	<b>&lt; 8mΩ</b>
<b>Charge</b>	
<b>Standard Charge (1C)</b>	<b>450mA x 15h</b>
<b>Trickle Charge (0.05C)</b>	<b>225mA x 1.2h</b>
<b>Discharge Cut-off Voltage</b>	<b>1.0V</b>
<b>Max Dimension (with tube)</b>	
<b>Diameter</b>	<b>33.0mm</b>
<b>Height</b>	<b>60.5mm</b>
<b>Weight</b>	<b>138 g</b>
<b>Ambient Temperature</b>	
<b>Standard charge</b>	<b>0 ~ 60°C</b>
<b>Trickle charge</b>	<b>0 ~ 60°C</b>
<b>Discharge</b>	<b>-20 ~ 70°C</b>
<b>Storage</b>	<b>-20 ~ 45°C</b>

### Standard charge characteristics

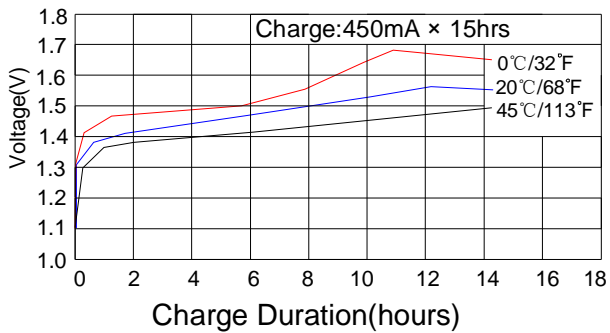

### Trickle charge characteristics

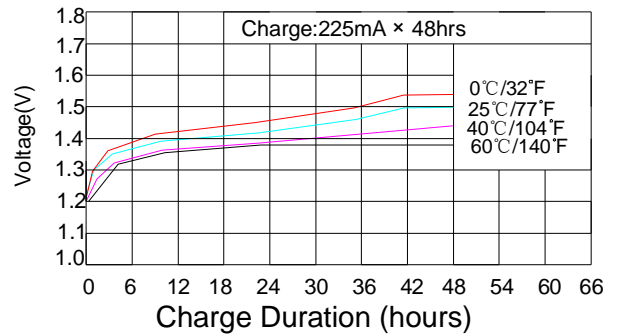

### Discharge characteristics

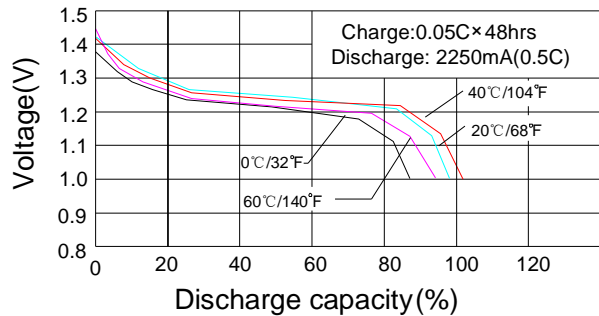

### Charge efficiency

