

D-SC1800H Specifications

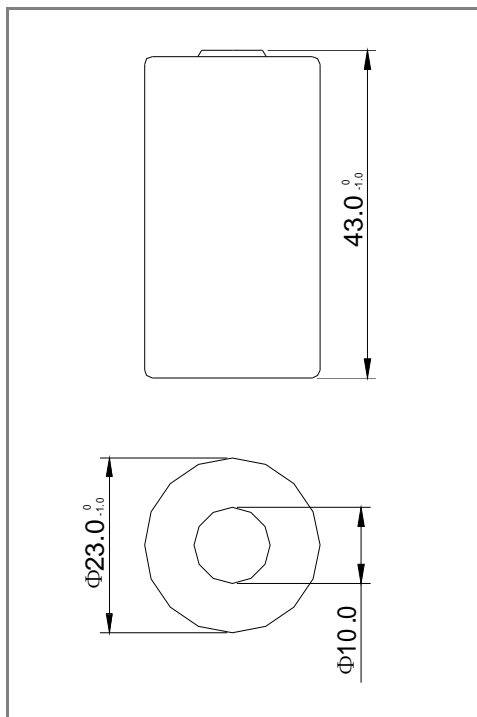

Nominal Capacity	1800mAh
Nominal Voltage	1.2V
Internal Impedance (at 1000Hz)	< 8mΩ
Charge	
Standard Charge (1C)	180mA x 15h
Trickle Charge (0.05C)	90mA x 1.2h
Discharge Cut-off Voltage	1.0V
Max Dimension (with tube)	
Diameter	23.0mm
Height	43.0mm
Weight	49 g
Ambient Temperature	
Standard charge	0 ~ 60°C
Trickle charge	0 ~ 60°C
Discharge	-20 ~ 70°C
Storage	-20 ~ 45°C

Standard charge characteristics

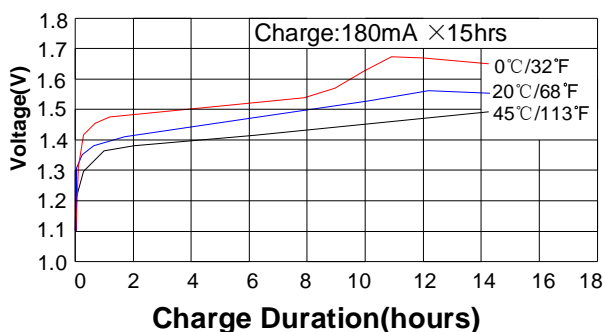

Trickle charge characteristics

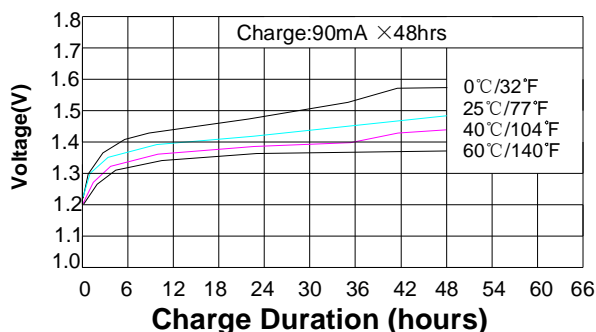

Discharge characteristics

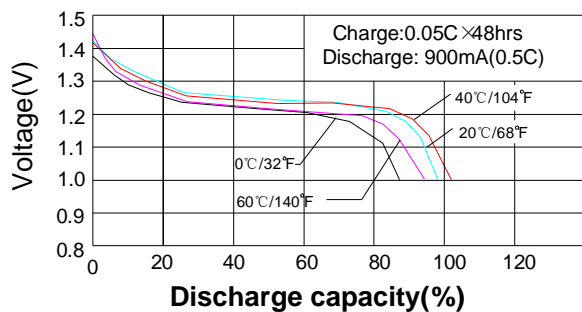

Charge efficiency

