

Montageanleitung

Ⓒ mounting instruction Ⓕ Notice de montage Ⓖ Instrukcja montaży
Ⓔ Instrucciones de montaje Ⓘ Istruzioni di montaggio

S36-A

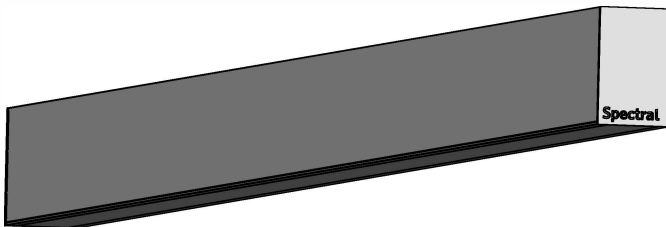

RIDI Leuchten GmbH
Hauptstrasse 31 - 33 · D-72417Jungingen
Tel. 07477/872-0 · Fax 07477/872-48
kontakt@ridi.de · www.ridi.de



- Ⓓ Für die Installation und für den Betrieb der Leuchten sind die nationalen Sicherheitsvorschriften zu beachten.
- ⒼⒹ Please note national safety instructions for installation and operation of this luminaire.
- Ⓕ Pour l'installation et le fonctionnement des luminaires il est impératif de respecter les normes nationales de sécurité en vigueur.
- ⒼⒾ W celu prawidłowej instalacji i poprawnego działania oprawy należy przestrzegać krajowych przepisów bezpieczeństwa.
- Ⓔ Para la instalación y la puesta en funcionamiento de las luminarias deben observarse las normas nacionales de seguridad.
- Ⓘ Per l'installazione e il funzionamento delle lampade si fa riferimento alle normative di sicurezza nazionali.

Ⓓ Die Lichtquelle dieser Leuchte ist nicht ersetzbar, wenn die Lichtquelle ihr Lebensdauerende erreicht hat, ist die gesamte Leuchte zu ersetzen.



- ⒼⒹ The light source of this luminaire is not replaceable. When light source has reached end of life-time the complete luminaire has to be replaced.
- Ⓕ La source lumineuse de ce luminaire n'est pas remplaçable. Quand la source lumineuse aura atteint la limite de sa durée de vie, le luminaire complet doit être remplacé.
- ⒼⒾ Nie ma możliwości wymiany źródła światła w tej oprawie oświetleniowej, po zakończeniu żywotności źródła światła, należy wymienić całą oprawę oświetleniową.
- Ⓔ La fuente lumínica de esta luminaria no se puede sustituir. Cuando la fuente lumínica ha alcanzado el final de su vida útil, hay que sustituir toda la luminaria.
- Ⓘ La sorgente di luce di questa lampada non è sostituibile, una volta esaurita la sua durata si deve sostituire l'intera lampada.

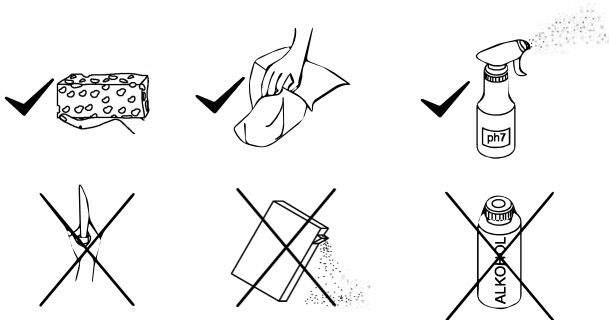

Optiken
optics
optiques
ópticas
optyka
ottica

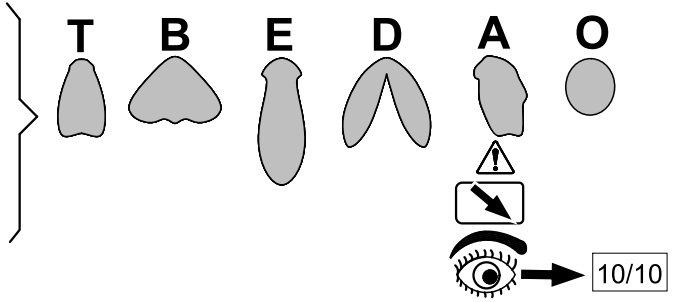
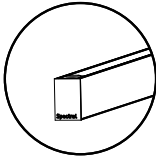

| Optiken | Type | L (mm) | B (mm) | H (mm) | A1 (mm) | | |
|---------|----------|--------|--------|--------|---------|-----|---------|
| | S36 900 | 900 | 36 | 57 | 394 | 130 | (A) |
| | S36 1200 | 1200 | 36 | 57 | 694 | 150 | (A) |
| | S36 1500 | 1500 | 36 | 57 | 994 | 180 | (A) |
| | S36 1800 | 1800 | 36 | 57 | 1279 | 225 | (A) |
| | S36 2400 | 2400 | 36 | 57 | 2x939 | 300 | (A) |
| | S36 3000 | 3000 | 36 | 57 | 2x1239 | 360 | (A) |
| | S36 ... | > 3000 | 36 | 57 | < 2300 | 360 | (B)+(C) |

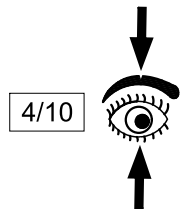

| Wanne LPO | Type | L (mm) | B (mm) | H (mm) | A1 (mm) | | |
|-----------|----------|--------|--------|--------|---------|-----|---------|
| | S36 900 | 900 | 36 | 72 | 394 | 150 | (A) |
| | S36 1200 | 1200 | 36 | 72 | 694 | 180 | (A) |
| | S36 1500 | 1500 | 36 | 72 | 994 | 225 | (A) |
| | S36 1800 | 1800 | 36 | 72 | 1279 | 300 | (A) |
| | S36 2400 | 2400 | 36 | 72 | 2x939 | 360 | (A) |
| | S36 3000 | 3000 | 36 | 72 | 2x1239 | 360 | (A) |
| | S36 ... | > 3000 | 36 | 72 | < 2300 | 360 | (B)+(C) |

(A)

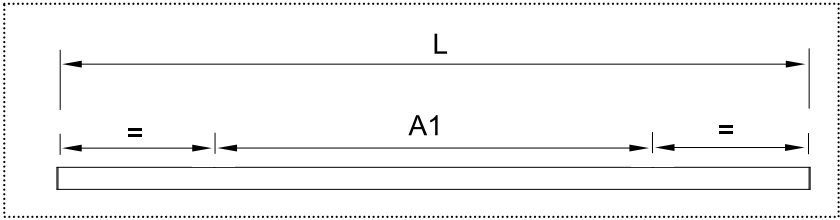

(B)

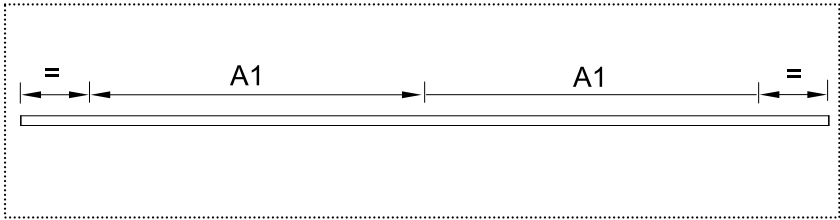

(C)

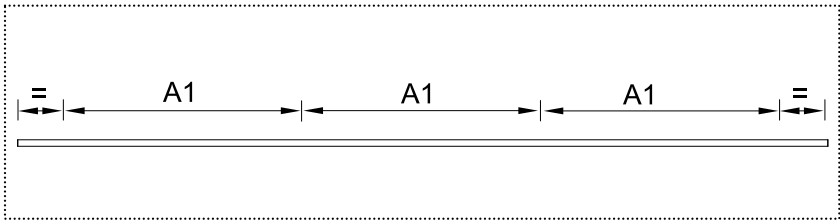

3/10

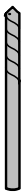

1

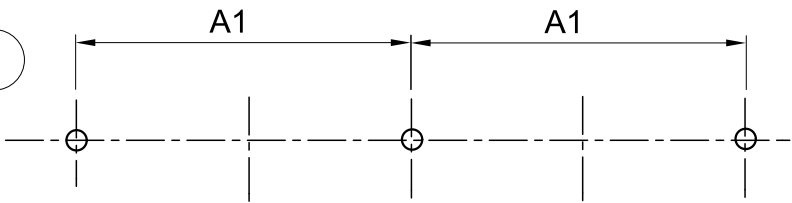

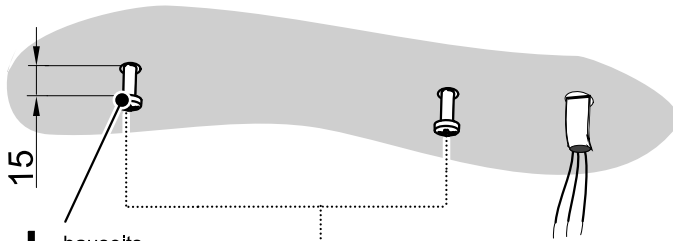

bauseits
 to be supplied on-site
 À prévoir sur place
 we własnym zakresie
 por parte del cliente
 a cura del cliente

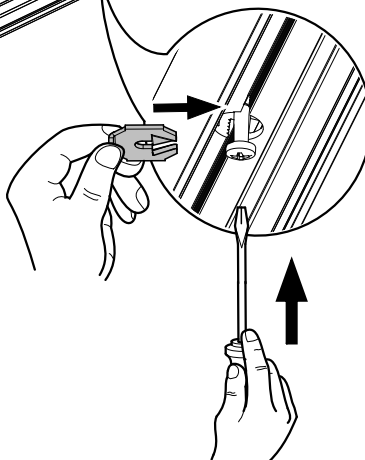
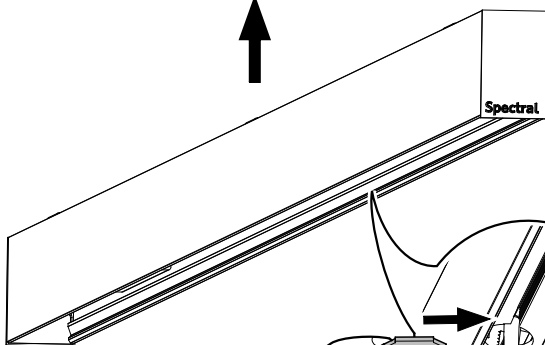
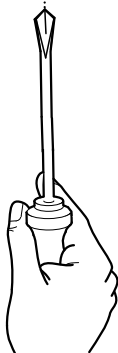

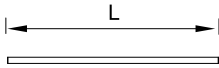
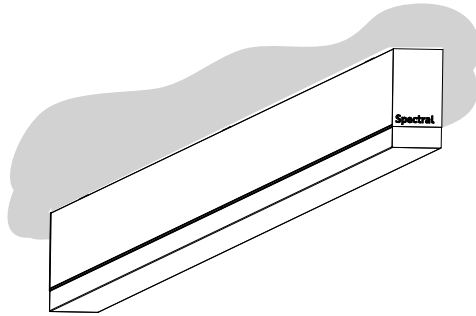

$L < 1m$

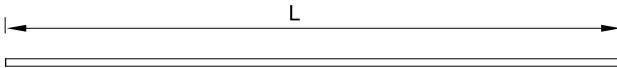

+



$L < 2m$

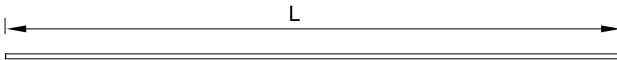

+



+



$L > 2m$

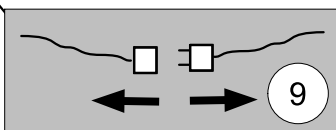
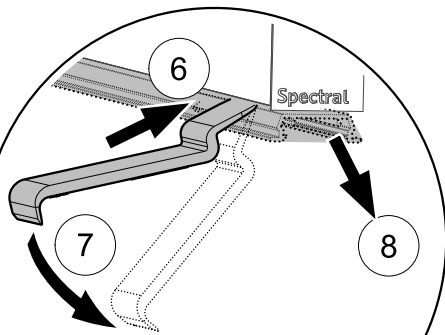
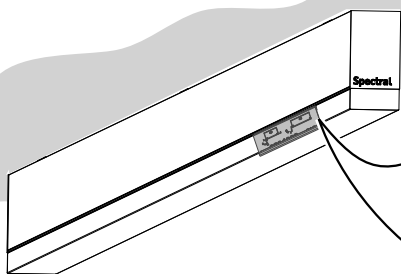
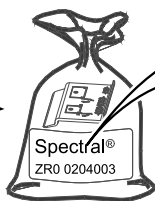
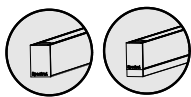
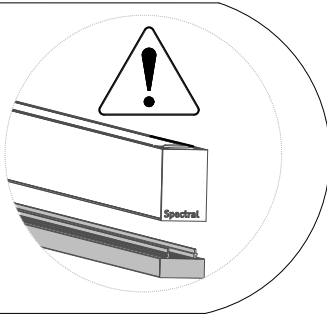
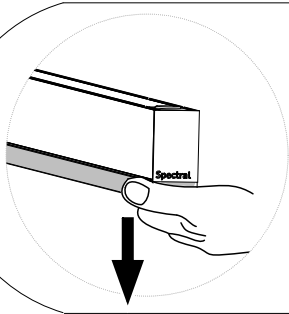
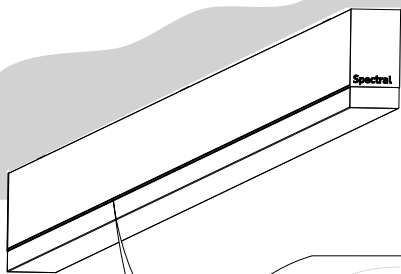

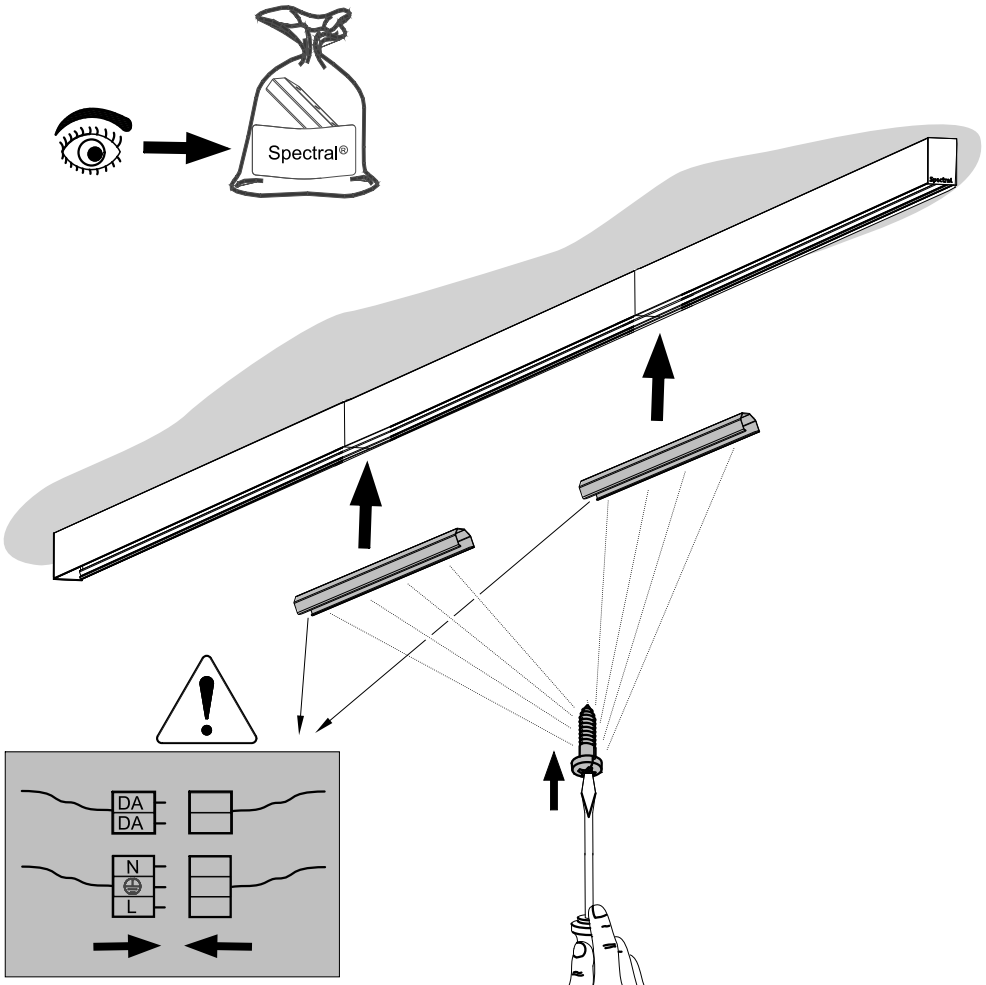

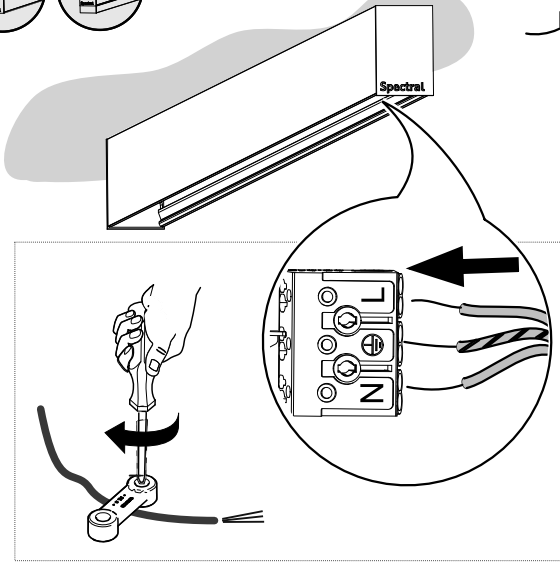
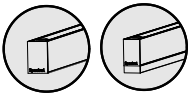

Volt ?



Spectral

 AC 220-240 V
 50-60 Hz

| | | |
|-------------------------|--------------|----|
| | qmm | A |
| | 0,5-1,0 | 9 |
| | sol. 1,5-2,5 | 12 |
| 0,5-2,5 mm ² | | |

| | | |
|------------|---------|----|
| | ∅ | A |
| | 0,8-1,2 | 9 |
| | 1,3-1,8 | 12 |
| max ∅1,8mm | | |

| | | |
|------------|---------|----|
| | ∅ | A |
| | 0,8-1,2 | 9 |
| | 1,3-1,8 | 12 |
| max ∅1,8mm | | |

