

wall mounting appliance inlet - housing dimensions 126x83



Product description	
BALS-Prd.-Nr	24409
EAN	4024941244091
Product category	TE wall mounting appliance inlet Quick-Connect, TE wall mounting appliance inlet Quick-Connect
Current	32A, 32A
Number of poles	3p, 3p
Arrangement of phases	2P+PE, 2P+PE
Position of earth contact	6 h, 6 h
Voltage	200 - 250V~, 200 - 250V~

Product description	
Frequency	50/60Hz, 50/60Hz
Protection degree	IP44, IP44
Colour code	blue RAL 5015, blue RAL 5015
Colour of appliance	Housing bottom grey RAL 7035, Housing top grey RAL 7035, Collar blue RAL 5015, Housing bottom grey RAL 7035, Housing top grey RAL 7035, Collar blue RAL 5015
Connection design	screwless spring-clamp technology, screwless spring-clamp technology
Maximum conductor size	6,0 qmm, 6,0 qmm
Cable entry	1xM25 top, 2xM25 bottom, 1xM25 top, 2xM25 bottom
Height	166mm, 166mm
Width	83mm, 83mm
Depth	128mm, 128mm
Dimension of enclosure	126x83 mm (HxW), 126x83 mm (HxW)
Material of enclosure	Polyamide, Polyamide
Contacts	The contact carrier is made of high temperature resistant material, the contacts are brass nickel plated, The contact carrier is made of high temperature resistant material, the contacts are brass nickel plated

Additional technical properties	
	The cable entry is one at top open and two at bottom closed, The cable entry is one at top open and two at bottom closed
	Lower part of housing rotatable by 180°, Lower part of housing rotatable by 180°

Additional technical properties	
	4 cut out fixing holes in the lower part of housing, 4 cut out fixing holes in the lower part of housing

Logistics data	
Weight/pcs	0.316 kg / Piece
Packaging	Bag
Content amount	1 ST
EAN	4024941244091
Length	128 mm
Width	83 mm
Height	166 mm
Weight	0.317 kg
Volume	1,763.584 ccm
Packaging	Carton
Content amount	10 ST
EAN	4024941822954
Length	330 mm
Width	216 mm
Height	260 mm
Weight	3.386 kg
Volume	17,062.5 ccm

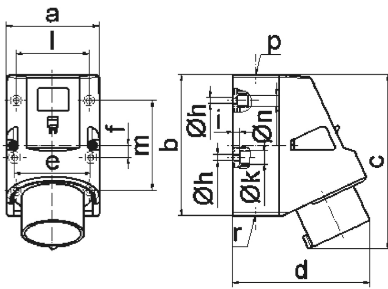

5 MB 45

Ampere	16	32	32	32
Polzahl	5	3	4	5
a	83,0	83,0	83,0	83,0
b	126,0	126,0	126,0	126,0
c	155,5	165,0	165,0	166,0
d	122,0	128,0	128,0	130,0
e	68,0	68,0	68,0	68,0
f	11,0	11,0	11,0	11,0
h ø	5,5	5,5	5,5	5,5
i	6,5	6,5	6,5	6,5
k ø	12,0	12,0	12,0	12,0
l	65,0	65,0	65,0	65,0
m	80,0	80,0	80,0	80,0
n ø	10	10,0	10,0	10,0
p	M25	M25	M25	M25
r	2xM25	2xM25	2xM25	2xM25
Leiter mm ² min	1	2,5	2,5	2,5
Leiter mm ² max	2,5	6	6	6