

# RED SSD/MS OR (PG/PG)

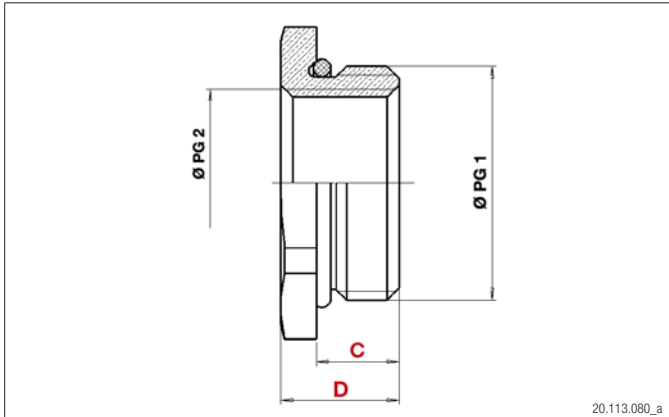

20.113.080\_a



20.113.080\_b

**MAT** Messing vernickelt  
Laiton nickelé  
Nickel plated brass

**RoHS**

**TEMP** -25°C bis +120°C  
-25°C à +120°C  
-25°C to +120°C

**NORM** GUIDE UTE 68312

## Reduktion SSD/MS OR





Mit Sechskant und O-Ring. Selbstdichtende Ausführung. Durch den Sechskant sind keine Spezialwerkzeuge für die Montage notwendig. Gewinde PG/PG.

## Réducteur SSD/MS OR

6 pans et joint torique intégré côté filetage. Exécution autoétanchéifiante. Les 6 pans facilitent le montage sans outil spécial. Filetages PG/PG.

## Reducer SSD/MS OR



Hexagonal and with O-ring. No special tools required. PG/PG threads.

		<b>C</b> mm	<b>D</b> mm			Plica-Nr.	E-Nr.	VE
PG9	PG7	5	8	17	vernickelt	91.6102.718	126 345 010	100
PG11	PG7	6	9	19	vernickelt	91.6102.721	126 345 020	100
	PG9	6	9	19	vernickelt	91.6102.734	126 345 021	100
PG13.5	PG7	6	8.5	21	vernickelt	91.6102.726	126 345 030	100
	PG9	6	9	21	vernickelt	91.6102.742	126 345 031	100
	PG11	6	9	21	vernickelt	91.6102.777	126 345 032	100
PG16	PG7	7	10	23	vernickelt	91.6102.731	126 345 040	100
	PG9	6	9	23	vernickelt	91.6102.750	126 345 041	100
	PG11	6	9	23	vernickelt	91.6102.785	126 345 042	100
	PG13.5	6	9	23	vernickelt	91.6102.815	126 345 043	100
PG21	PG9	7	10	29	vernickelt	91.6102.760		100
	PG11	7	10	29	vernickelt	91.6102.793	126 345 052	100
	PG13.5	7	10	29	vernickelt	91.6102.823	126 345 053	100
	PG16	7	10	29	vernickelt	91.6102.858	126 345 054	100
PG29	PG11	8	11	39	vernickelt	91.6102.811		100
	PG13.5	8	11	39	vernickelt	91.6102.831	126 345 063	50
	PG16	8	11	39	vernickelt	91.6102.866	126 345 064	50
	PG21	8	11	39	vernickelt	91.6102.890	126 345 065	50
PG36	PG13.5	8	11	50	vernickelt	91.6102.836		100
	PG16	8	11	50	vernickelt	91.6102.900		25
	PG21	8	11	50	vernickelt	91.6102.904	126 345 075	50
	PG29	8	11	50	vernickelt	91.6102.920	126 345 076	25

**Kabelverschraubungen**  
Reduktionen Messing

**Presse-étoupes**  
Réducteur laiton

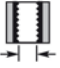
**Cable glands**  
Reducer brass

		<b>C</b> mm	<b>D</b> mm	 mm			<b>Plica-Nr.</b>	<b>E-Nr.</b>	<b>VE</b>
PG42	PG29	10	14	64		vernickelt	91.6102.939	126 345 196	25
	PG36	10	14	64		vernickelt	91.6102.941	126 345 197	25
PG48	PG21	10	14	64		vernickelt	91.6102.910		100
	PG29	10	14	64		vernickelt	91.6102.948		100
	PG36	10	14	64		vernickelt	91.6102.955	126 345 151	25
PG2"	PG42	10	14	64		vernickelt	91.6102.957	126 345 152	25
	PG29	11.5	15	64		vernickelt	91.6102.962	126 345 153	25
	PG36	11.5	15	64		vernickelt	91.6102.963	126 345 087	25
	PG42	11.5	15	64		vernickelt	91.6102.967	126 345 819	25