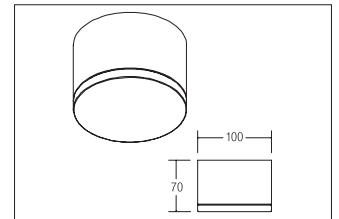

## LED surface mounted downlight

**Artikel-Nr. 12068173**

LED surface mounted downlight, white, round. Surface mounting, Ceiling-mounted. Mounting method: Surface mounting, Place of installation: Ceiling-mounted, Material: Aluminium / Plastic, Degree of protection: according to DIN EN 60529 IP20, Protection class: (EN 61140) I, Voltage: 230V AC 50Hz, Power: 12.1W, Amount of light sources / fittings: 1.0 Qty, Luminous flux: 600lm, Colour temperature: 3000K, Light colour : White, Beam angle: 120°, With control gear: Yes, Type of dimming: on/off. This luminaire contains incorporated and non-exchangeable LED light sources.

<b>Artikel-Nr.</b>	<b>12068173</b>		
<b>Stand:</b>	18.06.2021 19:09		
Colour of light	3000 K	Colour rendering	CRI > 80
Colour	White	Type of dimming	on/off
Beam angle	120 °	Outer diameter	100 mm
Amount of light sources / fittings	1 Qty	Voltage	230V AC 50Hz
Material	Aluminium / Plastic	Luminous flux	600 lm
Power	12,1 W	Degree of protection	IP20
Lamp	LED	Protection class	I
Shipping	Incl. converter for connection to the 230-V mains voltage	Height	70 mm
		Circuit type	Parallel conduction