

LED panel 620 x 620 mm

Artikel-Nr. 32048073

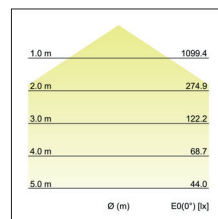
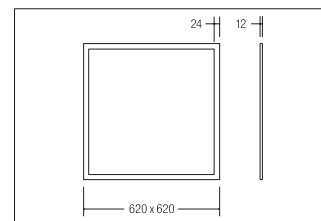
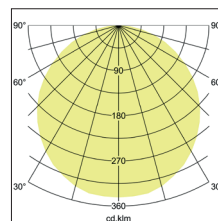
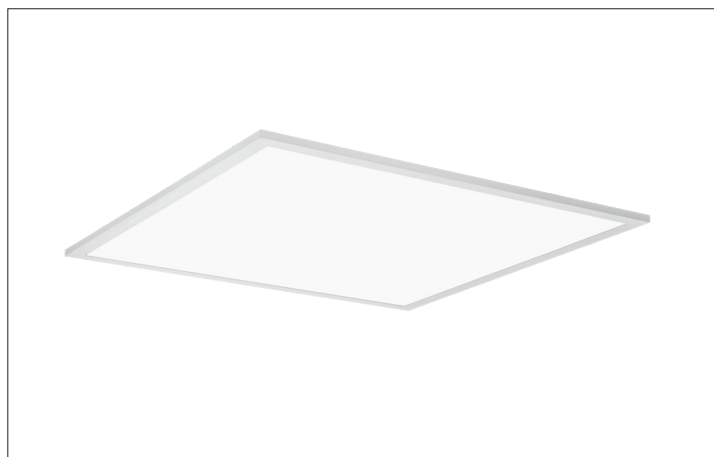

LED panel 620 x 620 mm, white, square. In a compact design, for installation in tool-less rapid assembly systems. Set including a converter for 230-V mains voltage, on/off switchable, dimensions of converter: L 145 x W 43 x H 30 mm. Mounting method: Recessed mounting, Place of installation: Ceiling-mounted, Material: Aluminium, Degree of protection: according to DIN EN 60529 IP40, Protection class: (EN 61140) II, Voltage: 230V AC 50Hz, Power: 39W, Amount of light sources / fittings: 1.0 Qty, Luminous flux: 3.359lm, Colour temperature: 3000 K, Light colour : White, Beam angle: 120°, With control gear: Yes.

Artikel-Nr.	32048073
Stand:	20.07.2021 16:15

Colour of light	3000 K
Colour	White
Amount of light sources / fittings	1 Qty
Material	Aluminium
Power	39 W
Lamp	LED
Shipping	Incl.n opal cover
Colour rendering	CRI > 80
Built-in width	620 mm
Built-in length	620 mm

Installation depth	12 mm
Voltage	230V AC 50Hz
Degree of protection	IP40
Protection class	II
Length	620 mm
Width	620 mm
Height	12 mm
Circuit type	Parallel conduction
Rated life time L80/B50 at 25 °C	50000 h