

# INSTRUCTION

# REGIOLUX

Regiolux GmbH  
 Hellinger Str. 3  
 D-97486 Königsberg/Bay.  
 Telefon (0 95 25) 89-0  
 Telefax (0 95 25) 89 73 4  
<http://www.regiolux.de>  
 e-Mail: [info@regiolux.de](mailto:info@regiolux.de)

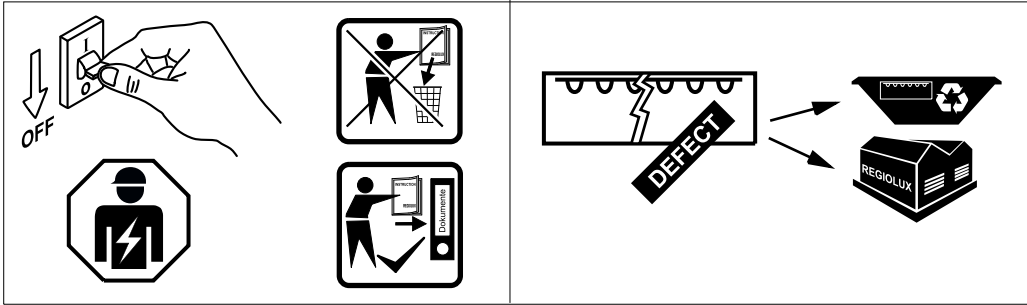

## IP20

**SRT-11A/0500 INKL. SRBK+SRTVL**

1920 0013 ...

**SRT-7A/0500 INKL. SRBK+SRTVL**

1920 0012 ...

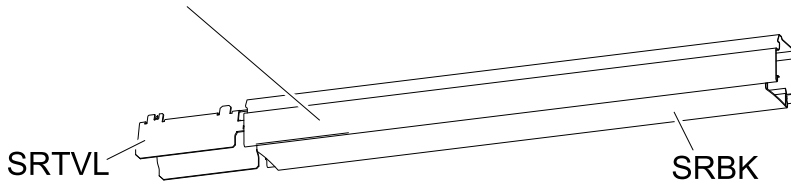

## IP64

**SRT-11A/0500 INKL. SRBKS+SRTVLS IP64**

1920 0015 ...

**SRT-7A/0500 INKL. SRBKS+SRTVLS IP64**

1920 0014 ...

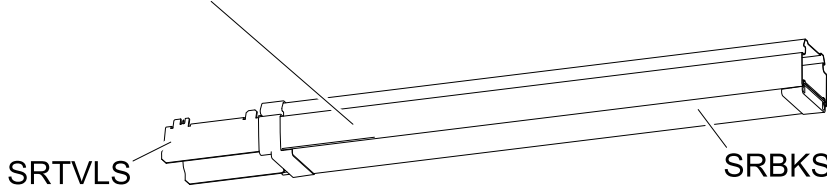

### Option A Auspeisung

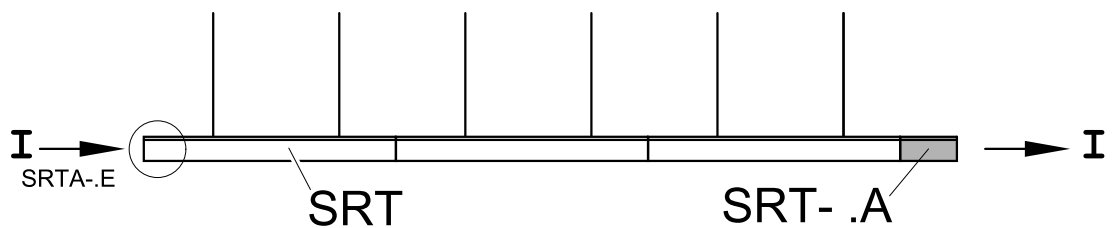

### Option B Mitteneinspeisung

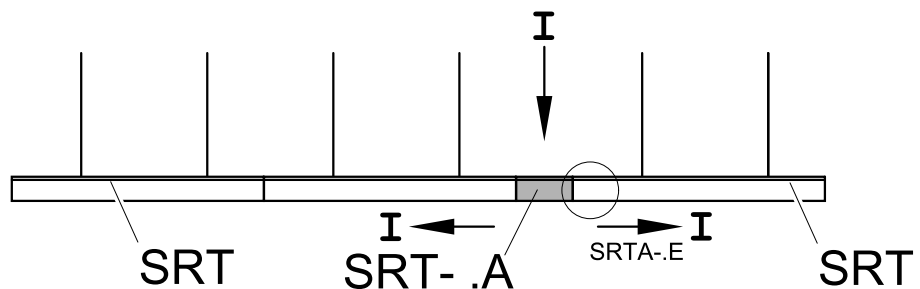

# MONTAGE

## Option A

SRT-.A

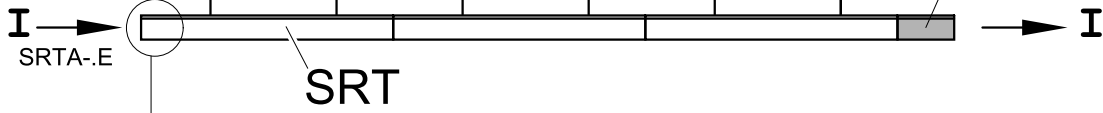

**SRTA-11E / SRTA-7E**

**SRT-.A**

1. Insert SRT-.A into the rail.

2. Remove the cap.

3. Connect the SRT-.A to the SRT rail.

4. Tighten the screw with a Torx 20 screwdriver (max 2 Nm).

5. Push the SRT-.A into the rail.

6. Connect the cable to the SRT-.A.

7. Push the cable into the rail.

8. Tighten the screw.

**Wiring Diagrams:**

**a:** Shows correct (green check) and incorrect (red X) cable connection to the terminal.

**b:** Shows correct (green check) and incorrect (red X) cable connection to the terminal.

**c:** Shows correct (green check) and incorrect (red X) cable connection to the terminal, with an eye icon indicating the viewing angle.

**SRTE / SRTES**

9

**Option 1**

10

**Option 2**

10

11

U=400 V

1,5-2,5 mm<sup>2</sup>

8+1 mm

12

# MONTAGE Option B

